



PALADIN
BRADCO

ADAPTER PLATES

FOR SKID-STEER LOADERS AND 3-POINT HITCHES



Features

- Rugged design
- Universal skid steer mount to category I or II 3-point hitch
- Category I or II 3-point to universal skid steer mount
- Universal skid steer weld-on adapter

Bradco® Adapter Plates by Paladin, permits you to use skid steer attachments on 3-point tractors or tractor 3-point implements on your skid steer.

UNIVERSAL SKID STEER MOUNT TO CATEGORY I OR II 3-POINT HITCH

- Permits use of tractor 3-point implements such as landscape tools on skid-steer loaders
- Built rigged to accommodate a wide variety of implements
- Adjustable top hook and sliding lower blocks make implement attachment easy
- Quick attaches to skid-steer loader and pins on the 3-point implement

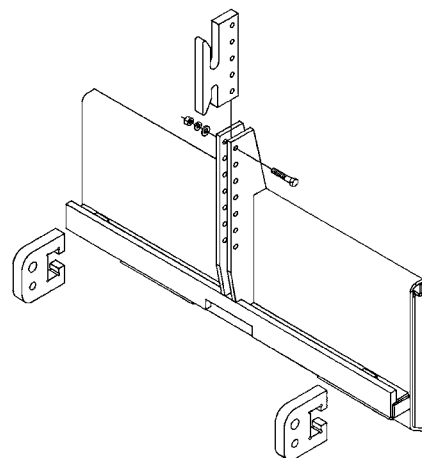

CATEGORY I OR II 3-POINT HITCH TO UNIVERSAL SKID STEER MOUNT

- Permits use of skid-steer attachments such as pallet forks and landscape tools on 3-point tractors
- Rugged design and positive locking wedges
- Quickly pins to tractor 3-point and wedge attaches to your skid-steer attachments
- Use with or without top link cylinder kit (shown)
- Top link cylinder kit replaces the tractor top link for hydraulically positioning attachments

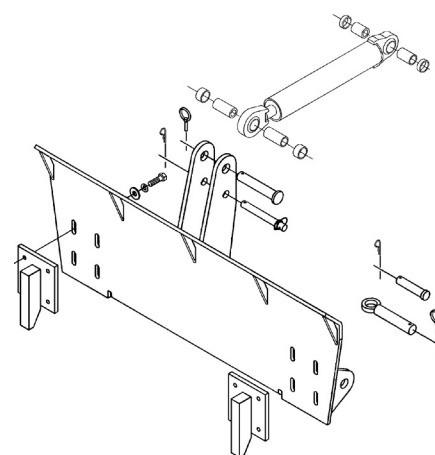

UNIVERSAL SKID STEER WELD-ON ADAPTER

- Permits use of non-universal attachments on skid-steer loaders with universal hitch
- Standard Duty: .25" plate with reinforcing bars behind engagement slots (shown)
- Heavy Duty: .38" plate with reinforcing bar behind engagement slots
- Extra Heavy Duty: .38 plate with full width .75" catch bar

