

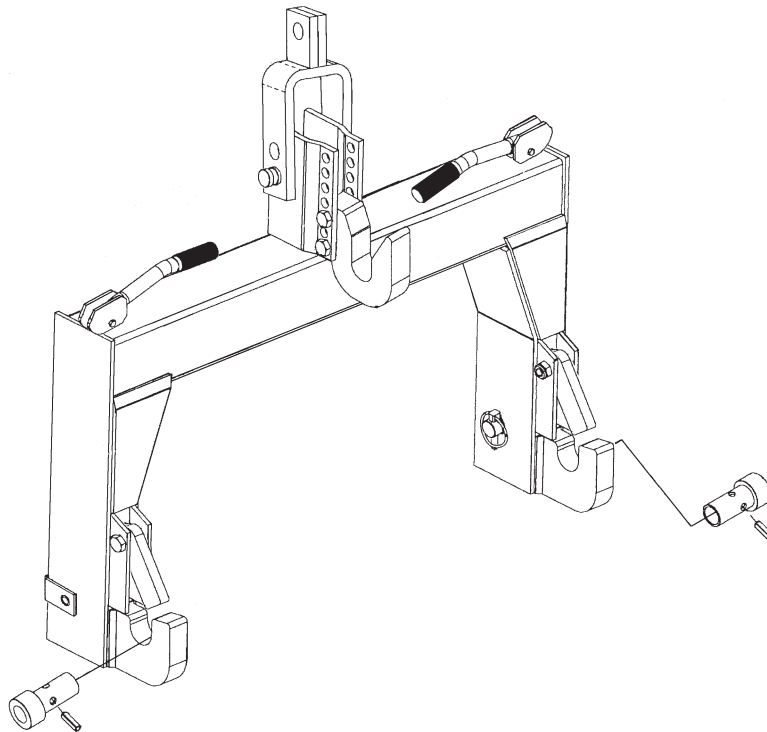

**KODIAK**  
BY PALADIN

# OPERATOR'S MANUAL

## QUICK HITCH CAT I 3-POINT



SERIAL NUMBER: \_\_\_\_\_

MODEL NUMBER: \_\_\_\_\_

Manual Number: KDK06-0227

Date: March 2022

Rev. 1



# TABLE OF CONTENTS

<b>PREFACE</b> .....	<b>5</b>
<b>SAFETY PRECAUTIONS</b>	
Safety Statements .....	6
General Safety Precautions.....	6-8
Equipment Safety Precautions .....	9-10
<b>PREOPERATION</b> .....	<b>11</b>
<b>INSTALLATION</b>	
Installation .....	12-13
Detaching.....	12
<b>OPERATION</b>	
Intended Use .....	14
Operation .....	14-16
Storage .....	17
Lift Points .....	17
Tie Down Points.....	17
Transporting.....	17
<b>MAINTENANCE</b>	
General information .....	18
<b>SPECIFICATIONS</b>	
Bolt Torque Specifications .....	19
<b>PARTS / WARRANTY</b> .....	<b>21</b>

**THIS PAGE  
IS INTENTIONALLY  
BLANK**

# PREFACE

## GENERAL COMMENTS

Congratulations on the purchase of your new product! This product was carefully designed and manufactured to give you many years of dependable service. Only minor maintenance (such as cleaning and lubricating) is required to keep it in top working condition. Be sure to observe all maintenance procedures and safety precautions in this manual and on any safety decals located on the product and on any equipment on which the attachment is mounted.

This manual has been designed to help you do a better, safer job. Read this manual carefully and become familiar with its contents.

**WARNING!**  **Never let anyone operate this unit without reading the "Safety Precautions" and "Operating Instructions" sections of this manual. Always choose hard, level ground to park the vehicle on and set the brake so the unit cannot roll.**

Unless noted otherwise, right and left sides are determined from the operator's control position when facing the attachment.

**NOTE:** The illustrations and data used in this manual were current (according to the information available to us) at the time of printing, however, we reserve the right to redesign and change the attachment as may be necessary without notification.

## BEFORE OPERATION

The primary responsibility for safety with this equipment falls to the operator. Make sure the equipment is operated only by trained individuals that have read and understand this manual. If there is any portion of this manual or function you do not understand, contact your local authorized dealer or the manufacturer to obtain further assistance. Keep this manual available for reference. Provide the manual to any new owners and/or operators.

## SAFETY ALERT SYMBOL



This is the "Safety Alert Symbol" used by this industry. This symbol is used to warn of possible injury. Be sure to read all warnings carefully. They are included for your safety and for the safety of others working with you.

## SERVICE

Use only manufacturer replacement parts. Substitute parts may not meet the required standards.

Record the model and serial number of your unit on the cover of this manual. The parts department needs this information to insure that you receive the correct parts.

## SOUND AND VIBRATION

Sound pressure levels and vibration data for this attachment are influenced by many different parameters: some items are listed below (not inclusive):

- prime mover type, age, condition, with or without cab enclosure and configuration
- operator training, behavior, stress level
- job site organization, working material condition, environment

Based on the uncertainty of the prime mover, operator, and job site, it is not possible to get precise machine and operator sound pressure levels or vibration levels for this attachment.

**NOTE:** A list of all Paladin Patents can be found at <http://www.paladinattachments.com/patents.asp>.

## SAFETY STATEMENTS



THIS SYMBOL BY ITSELF OR WITH A WARNING WORD THROUGHOUT THIS MANUAL IS USED TO CALL YOUR ATTENTION TO INSTRUCTIONS INVOLVING YOUR PERSONAL SAFETY OR THE SAFETY OF OTHERS. FAILURE TO FOLLOW THESE INSTRUCTIONS CAN RESULT IN INJURY OR DEATH.



### **DANGER**

THIS SIGNAL WORD INDICATES A HAZARDOUS SITUATION WHICH, IF NOT AVOIDED, WILL RESULT IN DEATH OR SERIOUS INJURY.



### **WARNING**

THIS SIGNAL WORD INDICATES A HAZARDOUS SITUATION WHICH, IF NOT AVOIDED, COULD RESULT IN DEATH OR SERIOUS INJURY.



### **CAUTION**

THIS SIGNAL WORD INDICATES A HAZARDOUS SITUATION WHICH, IF NOT AVOIDED, COULD RESULT IN MINOR OR MODERATE INJURY.

### **NOTICE**

NOTICE IS USED TO ADDRESS PRACTICES NOT RELATED TO PHYSICAL INJURY.

## GENERAL SAFETY PRECAUTIONS

### **WARNING!**



#### **READ MANUAL PRIOR TO INSTALLATION**

Improper installation, operation, or maintenance of this equipment could result in serious injury or death. Operators and maintenance personnel should read this manual, as well as all manuals related to this equipment and the prime mover thoroughly before beginning installation, operation, or maintenance. **FOLLOW ALL SAFETY INSTRUCTIONS IN THIS MANUAL AND THE PRIME MOVER'S MANUAL(S).**



#### **READ AND UNDERSTAND ALL SAFETY STATEMENTS**

Read all safety decals and safety statements in all manuals prior to operating or working on this equipment. Know and obey all OSHA regulations, local laws, and other professional guidelines for your operation. Know and follow good work practices when assembling, maintaining, repairing, mounting, removing, or operating this equipment.



#### **KNOW YOUR EQUIPMENT**

Know your equipment's capabilities, dimensions, and operations before operating. Visually inspect your equipment before you start, and never operate equipment that is not in proper working order with all safety devices intact. Check all hardware to ensure it is tight. Make certain that all locking pins, latches, and connection devices are properly installed and secured. Remove and replace any damaged, fatigued, or excessively worn parts. Make certain all safety decals are in place and are legible. Keep decals clean, and replace them if they become worn or hard to read.

## GENERAL SAFETY PRECAUTIONS

### WARNING!



#### PROTECT AGAINST FLYING DEBRIS

Always wear proper safety glasses, goggles, or a face shield when driving pins in or out, or when any operation causes dust, flying debris, or any other hazardous material.

### WARNING!



#### LOWER OR SUPPORT RAISED EQUIPMENT

Do not work under raised booms without supporting them. Do not use support material made of concrete blocks, logs, buckets, barrels, or any other material that could suddenly collapse or shift positions. Make sure support material is solid, not decayed, warped, twisted, or tapered. Lower booms to ground level or on blocks. Lower booms and attachments to the ground before leaving the cab or operator's station.

### WARNING!



#### USE CARE WITH HYDRAULIC FLUID PRESSURE

Hydraulic fluid under pressure can penetrate the skin and cause serious injury or death. Hydraulic leaks under pressure may not be visible. Before connecting or disconnecting hydraulic hoses, read your prime mover's operator's manual for detailed instructions on connecting and disconnecting hydraulic hoses or fittings.

- Keep unprotected body parts, such as face, eyes, and arms as far away as possible from a suspected leak. Flesh injected with hydraulic fluid may develop gangrene or other permanent disabilities.
- If injured by injected fluid, see a doctor at once. If your doctor is not familiar with this type of injury, ask him to research it immediately to determine proper treatment.
- Wear safety glasses, protective clothing, and use a piece of cardboard or wood when searching for hydraulic leaks. **DO NOT USE YOUR HANDS!** **SEE ILLUSTRATION.**

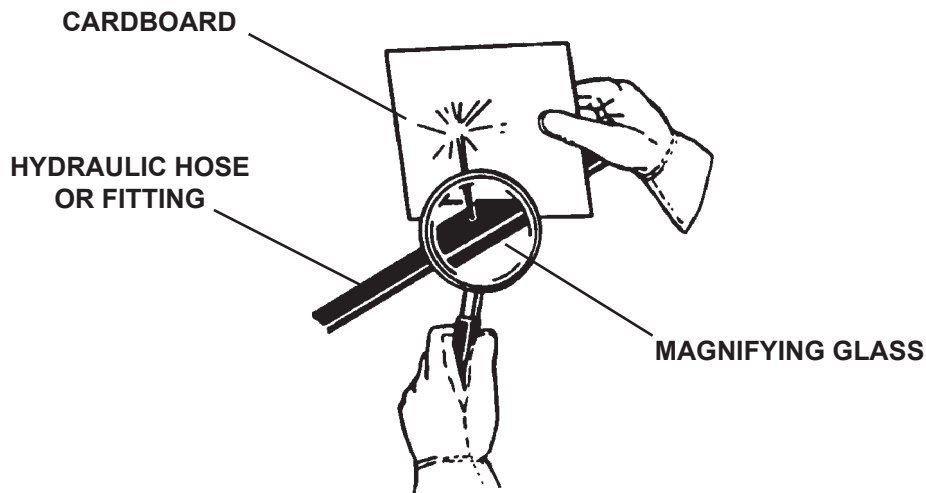

## GENERAL SAFETY PRECAUTIONS

### WARNING!



#### DO NOT MODIFY MACHINE OR ATTACHMENTS

Modifications may weaken the integrity of the attachment and may impair the function, safety, life, and performance of the attachment. When making repairs, use only the manufacturer's genuine parts, following authorized instructions. Other parts may be substandard in fit and quality. Never modify any ROPS (Roll Over Protective Structure) or FOPS (Falling Object Protective Structure) equipment or device. Any modifications must be authorized in writing by the manufacturer.

### WARNING!



#### SAFELY MAINTAIN AND REPAIR EQUIPMENT

- Do not wear loose clothing or any accessories that can catch in moving parts. If you have long hair, cover or secure it so that it does not become entangled in the equipment.
- Work on a level surface in a well-lit area.
- Use properly grounded electrical outlets and tools.
- Use the correct tools for the job at hand. Make sure they are in good condition for the task required.
- Wear the protective equipment specified by the tool manufacturer.



#### SAFELY OPERATE EQUIPMENT

Do not operate equipment until you are completely trained by a qualified operator in how to use the controls, know its capabilities, dimensions, and all safety requirements. See your machine's manual for these instructions.

- Keep all step plates, grab bars, pedals, and controls free of dirt, grease, debris, and oil.
- Never allow anyone to be around the equipment when it is operating.
- Do not allow riders on the attachment or the prime mover.
- Do not operate the equipment from anywhere other than the correct operator's position.
- Never leave equipment unattended with the engine running, or with this attachment in a raised position.
- Do not alter or remove any safety feature from the prime mover or this attachment.
- Know your work site safety rules as well as traffic rules and flow. When in doubt on any safety issue, contact your supervisor or safety coordinator for an explanation.

### WARNING!



#### CALIFORNIA PROPOSITION 65 WARNING

This product may contain a chemical known to the state of California to cause cancer, or birth defects or other reproductive harm. [www.P65Warnings.ca.gov](http://www.P65Warnings.ca.gov)



## EQUIPMENT SAFETY PRECAUTIONS

### WARNING!



#### KNOW WHERE UTILITIES ARE

Observe overhead electrical and other utility lines. Be sure equipment will clear them. When digging, call your local utilities for location of buried utility lines, gas, water, and sewer, as well as any other hazard you may encounter.

### WARNING!



#### EXPOSURE TO RESPIRABLE CRYSTALLINE SILICA DUST ALONG WITH OTHER HAZARDOUS DUSTS MAY CAUSE SERIOUS OR FATAL RESPIRATORY DISEASE.

It is recommended to use dust suppression, dust collection and if necessary personal protective equipment during the operation of any attachment that may cause high levels of dust.

### WARNING!



#### REMOVE PAINT BEFORE WELDING OR HEATING

Hazardous fumes/dust can be generated when paint is heated by welding, soldering or using a torch. Do all work outside or in a well ventilated area and dispose of paint and solvent properly. Remove paint before welding or heating.

When sanding or grinding paint, avoid breathing the dust. Wear an approved respirator. If you use solvent or paint stripper, remove stripper with soap and water before welding. Remove solvent or paint stripper containers and other flammable material from area. Allow fumes to disperse at least 15 minutes before welding or heating.

### WARNING!



#### END OF LIFE DISPOSAL

At the completion of the useful life of the unit, drain all fluids and dismantle by separating the different materials (rubber, steel, plastic, etc.). Follow all federal, state and local regulations for recycling and disposal of the fluid and components.



#### OPERATING THE ATTACHMENT

- Operate only from the operator's station.
- Do not stand between prime mover and attachment during installation.
- Avoid steep hillside operation which could cause the prime mover to overturn. Consult your prime move operator's and safety manuals for maximum incline allowable.
- Reduce speed when driving over rough terrain, on a slope, or turning, to avoid overturning the vehicle.
- An operator must not use drugs or alcohol, which can change his or her alertness or coordination. An operator taking prescription or over-the-counter drugs should seek medical advice on whether or not he or she can safely operate equipment.
- Before exiting the prime mover, lower the attachment to the ground, apply the brakes, turn off engine and remove the key.

# EQUIPMENT SAFETY PRECAUTIONS



## TRANSPORTING THE ATTACHMENT

- Travel only with the attachment in a safe transport position to prevent uncontrolled movement. Drive slowly over rough ground and on slopes.
- When transporting on a trailer: Secure attachment using tie down accessories that are capable of maintaining attachment stability.
- Use extra care when loading or unloading the attachment onto a truck or trailer.
- When driving on public roads use safety lights, reflectors, Slow Moving Vehicle signs etc., to prevent accidents. Check local government regulations that may affect you.
- Do not drive close to ditches, excavations, etc., cave in could result.
- Do not smoke when refueling the prime mover. Allow room in the fuel tank for expansion. Wipe up any spilled fuel. Secure cap tightly when done.



## MAINTAINING THE ATTACHMENT

- Before performing maintenance, lower the attachment to the ground, apply the brakes, turn off the engine and remove the key.
- Never perform any work on the attachment unless you are authorized and qualified to do so. Always read the operator manual's before any repair is made. After completing maintenance or repair, check for correct functioning of the attachment. If not functioning properly, always tag "DO NOT OPERATE" until all problems are corrected.
- Worn, damaged, or illegible safety decals must be replaced. New safety decals can be ordered from Paladin.
- Never work under a raised attachment unless it is securely blocked.

# PREOPERATION

## NOMENCLATURE

The purpose of this diagram is to acquaint you with the various names of the Quick Hitch and implement mounting components. This knowledge will be helpful when reading through this manual or when ordering service parts.

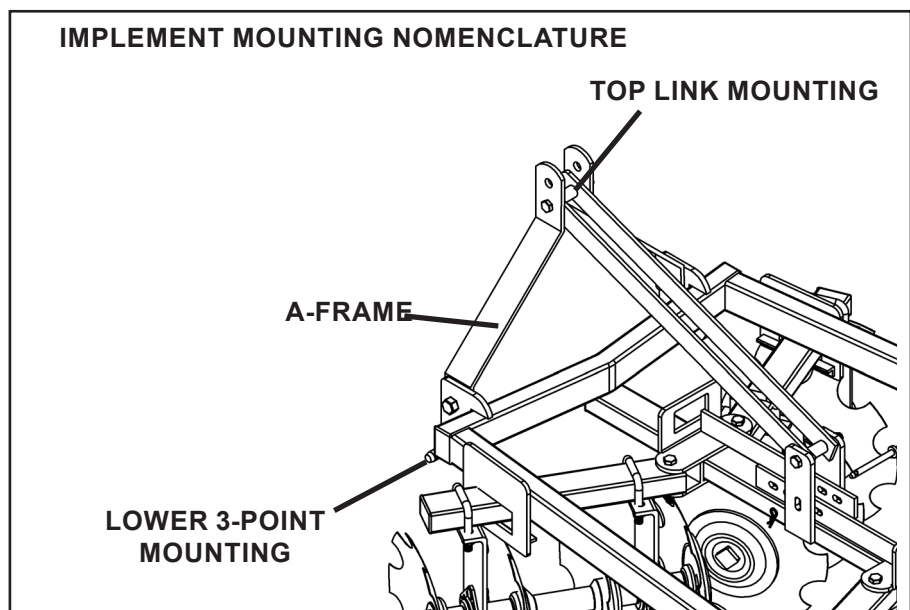
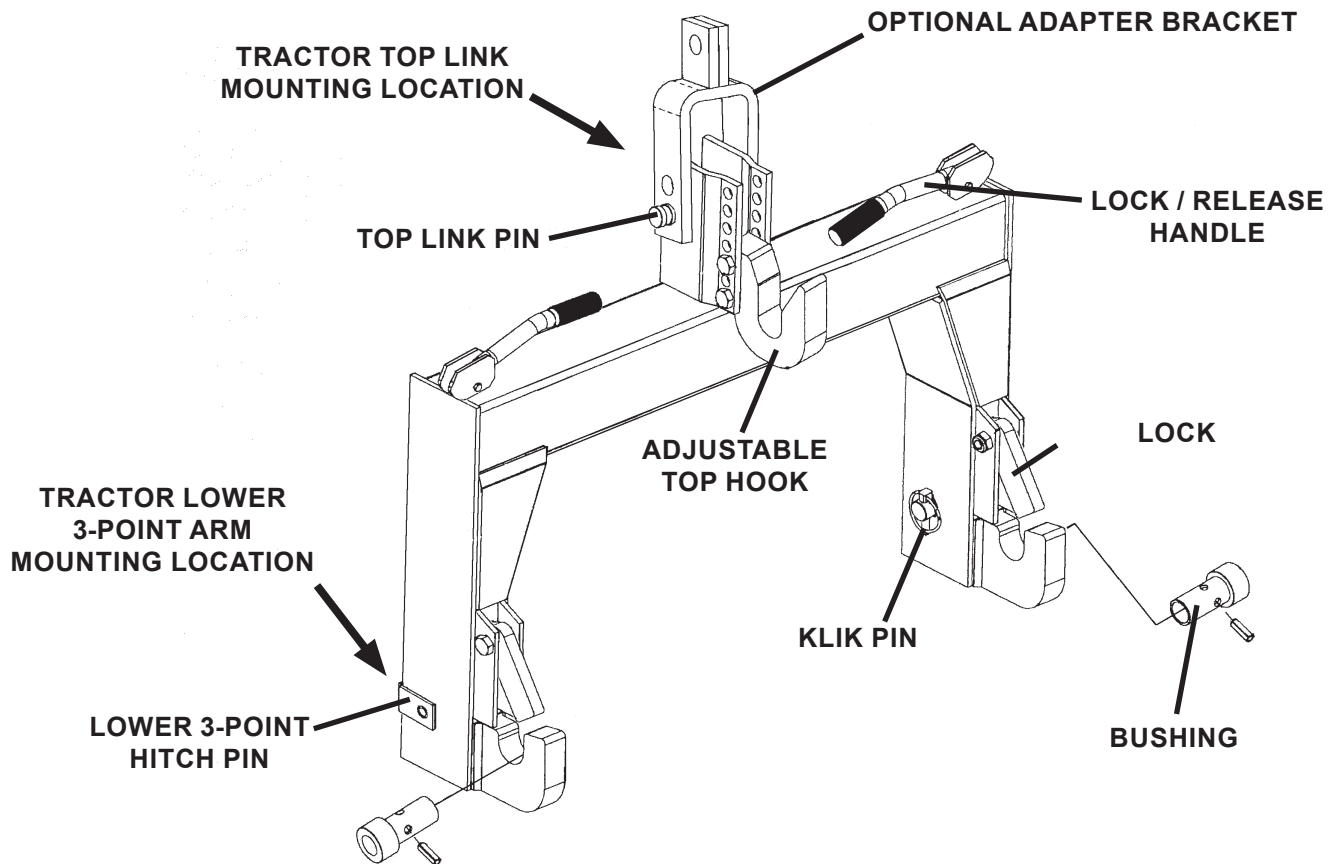

# INSTALLATION

**CAUTION!** Keep feet and all other body extremities out from under the lower 3-point hitch area during installation as the unit could fall causing injury.



**IMPORTANT:** Because of its weight, it is recommended to have a second person or an overhead hoist available when installing the Quick Hitch onto your 3-point hitch system.

## QUICK HITCH INSTALLATION

1. Park the tractor on level ground, set the parking brake, shut off the engine and remove the key before exiting the prime mover.
2. Position the Quick Hitch close to the tractor's 3-point lower lift arms with the mounting hooks facing away from the tractor.

FIGURE #1

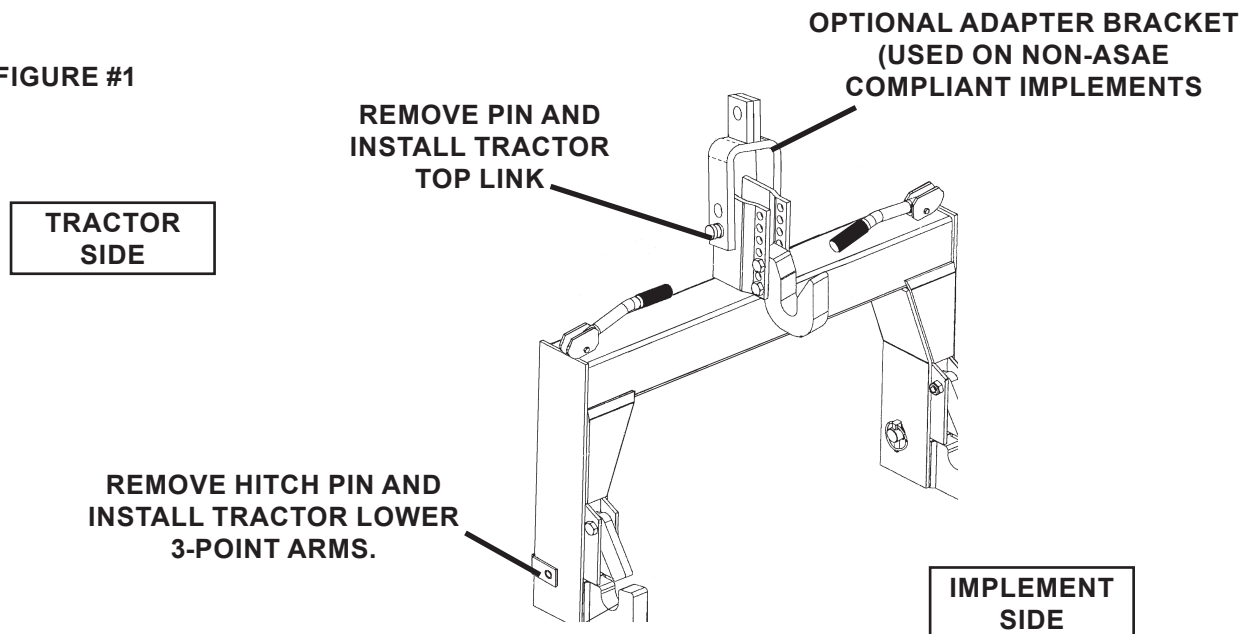

3. Remove the top link pin and lower 3-point hitch pins from the Quick Hitch.
4. Using an overhead hoist or a second person, raise one side at a time, aligning the lower 3-point hitch holes with the lower 3-point hitch arms on your tractor. Install the hitch pins and secure in place with klik pins provided.
5. Install the tractor top link to the Quick Hitch top link location using the top link pin and klik pin provided. If implement is not equipped with an ASAE mounting, attach the adapter bracket to this top link location to assist in the installation of the implement. **NOTE: There are two installation holes to assist in the vertical alignment of the implement.**
6. Adjust the tractor top link until the side plates on the Quick Hitch are perpendicular to the ground. Adjust the tractor lower lift arms up or down to level the Quick Hitch horizontally. (Refer to prime mover operator's manual.)
7. Verify all mounting procedures have been successfully completed.

# INSTALLATION

## DETACHING QUICK HITCH

**CAUTION!** Keep feet and all other body extremities out from under the lower 3-point hitch area during removal of the Quick Hitch as the unit could fall causing injury.



**IMPORTANT:** Because of its weight, it is recommended to have a second person or an overhead hoist available when removing the Quick Hitch from your 3-point hitch system.

1. Remove any attachment from the Quick Hitch.
2. Park the tractor on level ground close to storage location. Before exiting the prime mover, set parking brake, shut engine off and remove the key.
3. Either connect an overhead hoist (if available) to Quick Hitch frame for support or position a second person on one side to assist in the removal process.
4. Keeping a firm grip in the Quick Hitch, unhook top link from the Quick Hitch frame.
5. Remove lower 3-point arm hitch pins (one side at a time) securing the Quick Hitch to the tractor's lower 3-point hitch arms.
6. Carefully remove Quick Hitch from lower hitch arms. Reinstall pins into the Quick Hitch frame for storage.
7. Store Quick Hitch in a safe place where it can be easily located and not hidden or covered by overgrown vegetation.

# OPERATION

## INTENDED USE:

The Quick Hitch is designed to provide quick and easy 3-point hitch attachment and detachment of compatible implements. Use in any other way is considered contrary to the intended use.

**WARNING! Crush Hazard. Keep people and animals away from the area between the prime mover and implement during installation or detaching of an implement.**



## UPPER HOOK ADJUSTMENT:

1. Follow steps #1 through #3 in “**ASAE ATTACHMENT/IMPLEMENT INSTALLATION**”.
2. Verify that the upper hook aligns with the implement’s upper hitch point. If not: Set the parking brake, shut off engine, remove the key and exit the prime mover.
3. Remove the capscrews securing the top hook to the Quick Hitch. Move the upper hook up or down to align with the implements upper hitch point.
4. Re-install capscrews and torque to specification. See “Bolt Torque Specifications”.

## ASAE ATTACHMENT/IMPLEMENT INSTALLATION

1. Install the two bushings, either CAT I or CAT II depending on your hitch, over the lower hitch pins on your implement. Secure in place using the roll pins provided.

**NOTE: This will provide a tighter and more secure mounting surface in the lower hooks for locking the implement to the Quick Hitch. Additional Bushing Kits can be purchased from your local dealer for installing onto multiple implements for a quick-change of implements onto the Quick Hitch.**

2. Place the lock/release handles in the down position.
3. Lower Quick Hitch (prime mover 3-point arms) until the lower hooks are below the implement’s lower bushings and the upper hook is below the upper hitch point.
4. Carefully back the prime mover until the upper and lower hooks are directly under the lower bushings and the upper hitch point on the implement.
5. Slowly raise the 3-point arms until the lower hooks engage and “lock” onto the implement’s lower hitch points and the upper hook engages with the upper hitch point on the implement.

## NON-ASAE ATTACHMENT/IMPLEMENT INSTALLATION

1. Remove the two capscrews securing the top hook to the Quick Hitch and remove the top hook.
2. If the adapter bracket is not already installed onto your quick hitch: remove the top link pin securing the prime mover top link to the Quick Hitch and slide the adapter bracket over the top hook mounting bracket and reinstall the top link pin. See Figure #1

# OPERATION

**FIGURE #1**

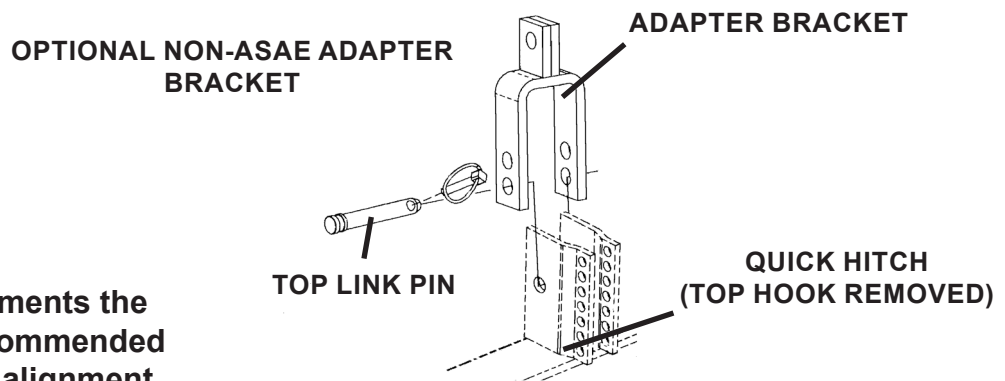

**NOTE: For most implements the front hole is recommended for best vertical alignment.**

3. Install the two CAT I bushings over the lower hitch pins on your implement. Secure in place using the roll pins provided if required. See Figure #2

**FIGURE #2**

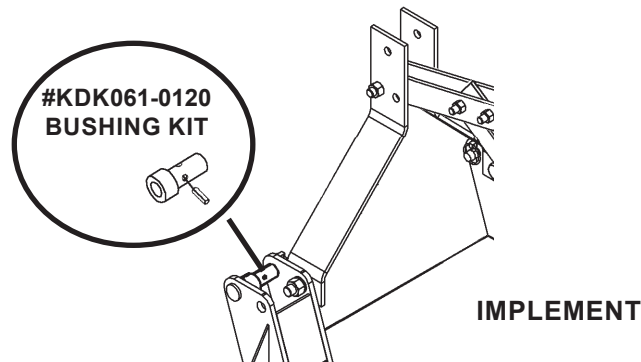

**NOTE: This will provide a tighter and more secure mounting surface in the lower hooks for locking the implement to the Quick Hitch. Additional Bushing Kits #KDK061-0120 can be purchased from your local dealer for installing onto multiple implements for aide in the quick-change of implements onto the Quick Hitch.**

4. Place the lock/release handles in the down position.
5. Lower Quick Hitch (prime mover 3-point arms) until the lower hooks are below the implement's lower bushings.
6. Carefully back the prime mover until the lower hooks are directly under the lower bushings.
7. Slowly raise the 3-point arms until the lower hooks engage and "lock" onto the implements lower hitch points.
8. Attach the implement upper hitch point to the optional adapter bracket with a suitable link pin (not provided).
9. Adjust the prime mover top link until the side plates on the Quick Hitch and implement are perpendicular to the ground. Adjust the lower lift arms up or down to level the Quick Hitch and implement horizontally. (Refer to prime mover operator's manual.)

## **CAT I TOP HITCH ADAPTER KIT ATTACHMENT/IMPLEMENT INSTALLATION**

For implements that do not provide enough clearance at the top mounting location to accommodate the Quick Hitch top hook.

## OPERATION

FIGURE #3

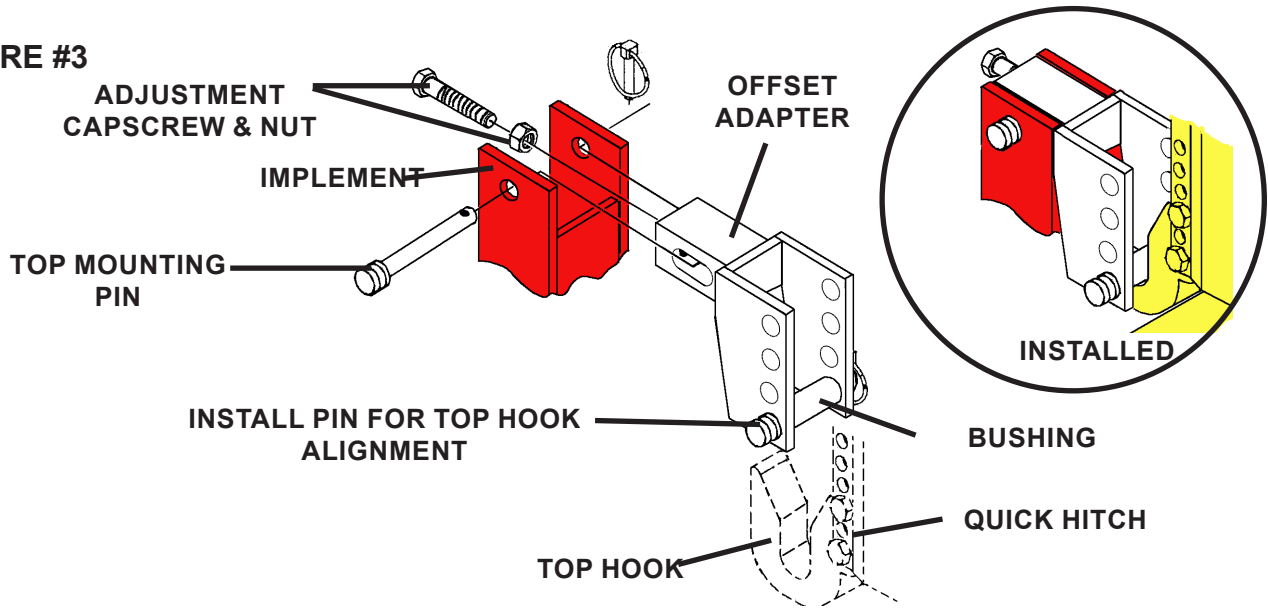

1. Place the offset adapter into the implement top mount location. See Figure #3
2. Install the top mounting pin and klik pin.
3. Tighten the adjustment capscrew to pull the adapter tight to the implement. Tighten the nut to secure the adjustment capscrew in position.
4. Install the pin and bushing in the offset adapter in a location that it will engage the top hook on the Quick Hitch.
5. Adjust the prime mover top link until the side plates on the Quick Hitch and implement are perpendicular to the ground. Adjust the lower lift arms up or down to level the Quick Hitch and implement horizontally. (Refer to prime mover operator's manual.)

## DETACHING ATTACHMENT/IMPLEMENT

1. Follow the detaching instructions in your prime mover and implement operator's manuals, park the prime mover on a hard level surface and lower the implement to the ground.
2. Before exiting the prime mover, set the parking brake, disengage PTO (if so equipped), shut off the engine and remove the key.

**IMPORTANT: wait for all movement to stop before approaching the implement.**

3. Disconnect driveline from prime mover PTO (if so equipped) and disconnect any hydraulic hoses.
4. **NON-ASAE implements ONLY:** Unhook the upper hitch point from the adapter bracket.
5. Pull the lock/release handles up into the "unlock" position. Verify the lower hook lock has retracted into the Quick Hitch frame allowing for removal of the implements 3-point lower hitch pins.
6. Restart the prime mover and lower the 3-point arms until the lower hooks are below the implements hitch pins.
7. Slowly drive the prime mover forward making sure Quick Hitch hooks clear implement hitch points and do not contact implement.
8. Set the parking brake, shut off the engine and remove the key before exiting the prime mover.
9. Lower the lock/release handles in preparation for installation of another implement.



# OPERATION

**NOTE: Detaching and storing implements in a position that will keep the lower and upper hitch points properly oriented for future installation will assist in a faster hook-up.**

## STORAGE

- Clean the unit thoroughly, removing all mud, dirt and grease.
- Inspect for visible signs of wear, breakage or damage. Order any parts required and make the necessary repairs to avoid delays upon removal from storage.
- Tighten loose nuts and capscrews.
- Store unit in a dry and protected place. Leaving the unit outside will materially shorten its life.

### **Additional Precautions for Long Term Storage:**

- Touch up all unpainted surfaces with paint to avoid rust.

## REMOVAL FROM STORAGE:

- Wash unit and replace any damage and/or missing parts.

## LIFT POINTS

Lifting points are identified by lifting decals where required. Lifting at other points is unsafe and can damage attachment. Do not attach lifting accessories around cylinders or in any way that may damage hoses or hydraulic components.

- Attach lifting accessories to unit at recommended lifting points.
- Bring lifting accessories together to a central lifting point.
- Lift gradually, maintaining the equilibrium of the unit.

**WARNING! USE LIFTING ACCESSORIES (CHAINS, SLINGS, ROPES, SHACKLES AND ETC.) THAT ARE CAPABLE OF SUPPORTING THE SIZE AND WEIGHT OF YOUR ATTACHMENT. Secure all lifting accessories in such a way to prevent unintended disengagement. Failure to do so could result in the attachment falling and causing serious personal injury or death.**



## TIE DOWN POINTS

Tie down points are identified by tie down decals where required. Securing to trailer at other points is unsafe and can damage attachment. Do not attach tie down accessories around cylinders or in any way that may damage hoses or hydraulic components.

- Attach tie down accessories to unit as recommended.
- Check unit stability before transporting.

**WARNING! VERIFY THAT ALL TIE DOWN ACCESSORIES (CHAINS, SLINGS, ROPES, SHACKLES AND ETC.) ARE CAPABLE OF MAINTAINING ATTACHMENT STABILITY DURING TRANSPORTING and are attached in such a way to prevent unintended disengagement or shifting of the unit. Failure to do so could result in serious personal injury or death.**



## TRANSPORTING

Follow all local government regulations that may apply along with recommended tie down points and any equipment safety precautions at the front of this manual when transporting your attachment.

# MAINTENANCE

## GENERAL INFORMATION

Regular maintenance is the key to long equipment life and safe operation. Maintenance requirements have been reduced to an absolute minimum. However, it is very important that these maintenance functions be performed as described below.

Procedure	Daily (Every 8 Hours)
Check all hardware and tighten if necessary. (See Bolt Torque Specifications)	✓
Replace any missing or damaged bolts or nuts with approved replacement parts.	✓
Inspect attachment for any worn parts or cracked welds. Repair as required.	✓
Lubricate moving parts.	✓

# BOLT TORQUE SPECIFICATIONS

## GENERAL TORQUE SPECIFICATION TABLES

Use the following charts when determining bolt torque specifications when special torques are not given. Always use grade 5 or better when replacing bolts.

## SAE BOLT TORQUE SPECIFICATIONS



**NOTE:** The following torque values are for use with extreme pressure lubricants, plating or hard washer applications. Increase torque 15% when using hardware that is unplated and either dry or lubricated with engine oil.

Bolt Size		SAE GRADE 5 TORQUE				SAE GRADE 8 TORQUE				Bolt head identification marks as per grade. NOTE: Manufacturing Marks Will Vary
		Pounds Feet		Newton-Meters		Pounds Feet		Newton-Meters		
Inches	Millimeters	UNC	UNF	UNC	UNF	UNC	UNF	UNC	UNF	
1/4	6.35	8	9	11	12	10	13	14	18	
5/16	7.94	14	17	19	23	20	25	27	34	
3/8	9.53	30	36	41	49	38	46	52	62	
7/16	11.11	46	54	62	73	60	71	81	96	
1/2	12.70	68	82	92	111	94	112	127	152	
9/16	14.29	94	112	127	152	136	163	184	221	
5/8	15.88	128	153	174	207	187	224	254	304	
3/4	19.05	230	275	312	373	323	395	438	536	
7/8	22.23	340	408	461	553	510	612	691	830	
1	25.40	493	592	668	803	765	918	1037	1245	
1-1/8	25.58	680	748	922	1014	1088	1224	1475	1660	
1-1/4	31.75	952	1054	1291	1429	1547	1700	2097	2305	
1-3/8	34.93	1241	1428	1683	1936	2023	2312	2743	3135	
1-1/2	38.10	1649	1870	2236	2535	2686	3026	3642	4103	

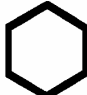

GRADE 2



GRADE 5





GRADE 8



## METRIC BOLT TORQUE SPECIFICATIONS

**NOTE:** The following torque values are for use with metric hardware that is unplated and either dry or lubricated with engine oil. Reduce torque 15% when using hardware that has extreme pressure lubricants, plating or hard washer applications.

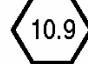
Bolt head identification marks as per grade.		
		

Size of Bolt	Grade No.	Pitch (mm)	Pounds Feet	Newton-Meters	Pitch (mm)	Pounds Feet	Newton-Meters
M6	5.6	1.0	3.6-5.8	4.9-7.9	-	-	-
	8.8		5.8-4	7.9-12.7		-	-
	10.9		7.2-10	9.8-13.6		-	-
M8	5.6	1.25	7.2-14	9.8-19	1.0	12-17	16.3-23
	8.8		17-22	23-29.8		19-27	25.7-36.6
	10.9		20-26	27.1-35.2		22-31	29.8-42
M10	5.6	1.5	20-25	27.1-33.9	1.25	20-29	27.1-39.3
	8.8		34-40	46.1-54.2		35-47	47.4-63.7
	10.9		38-46	51.5-62.3		40-52	54.2-70.5
M12	5.6	1.75	28-34	37.9-46.1	1.25	31-41	42-55.6
	8.8		51-59	69.1-79.9		56-68	75.9-92.1
	10.9		57-66	77.2-89.4		62-75	84-101.6
M14	5.6	2.0	49-56	66.4-75.9	1.5	52-64	70.5-86.7
	8.8		81-93	109.8-126		90-106	122-143.6
	10.9		96-109	130.1-147.7		107-124	145-168
M16	5.6	2.0	67-77	90.8-104.3	1.5	69-83	93.5-112.5
	8.8		116-130	157.2-176.2		120-138	162.6-187
	10.9		129-145	174.8-196.5		140-158	189.7-214.1
M18	5.6	2.0	88-100	119.2-136	1.5	100-117	136-158.5
	8.8		150-168	203.3-227.6		177-199	239.8-269.6
	10.9		175-194	237.1-262.9		202-231	273.7-313
M20	5.6	2.5	108-130	146.3-176.2	1.5	132-150	178.9-203.3
	8.8		186-205	252-277.8		206-242	279.1-327.9
	10.9		213-249	288.6-337.4		246-289	333.3-391.6

**THIS PAGE  
IS INTENTIONALLY  
BLANK**

## PARTS

In order to provide you with the most UP-TO-DATE part information, all parts for this attachment have been moved to our website at [www.paladinattachments.com/Manuals](http://www.paladinattachments.com/Manuals). Please use these diagrams and parts lists to locate replacement parts.

When servicing your attachment, remember to use only original manufacturer replacement parts. Substitute parts may not meet the standards required for safe, dependable operation.

To facilitate parts ordering when contacting the factory, please have the product control number (PCN or C/N) or model and serial number of your product ready to ensure that you receive the correct parts for your specific attachment.

The product control number, model and serial number for your attachment should be recorded in the space provided on the cover of this manual. This information may be obtained from the serial number identification plate located on your attachment.

**NOTE: Most daily and emergency parts orders (in stock) received by 10:30 A.M. (Eastern Standard Time) will be shipped UPS Ground the same day received. UPS Next Day orders must be received by 1:30 PM (Eastern Standard Time.)**

### SERVICE DEPARTMENT

(734) 996-9116

(800) 456-7100

### For Fax and E-mail Orders

PLC\_Sales@paladinattachments.com

(734) 996-9014

## WARRANTY

In order to provide you with the most UP-TO-DATE Warranty information, Paladin Warranty Statement and Warranty Procedures along with Warranty Registration and Claim Forms have been moved to our website at [www.paladinattachments.com](http://www.paladinattachments.com).