

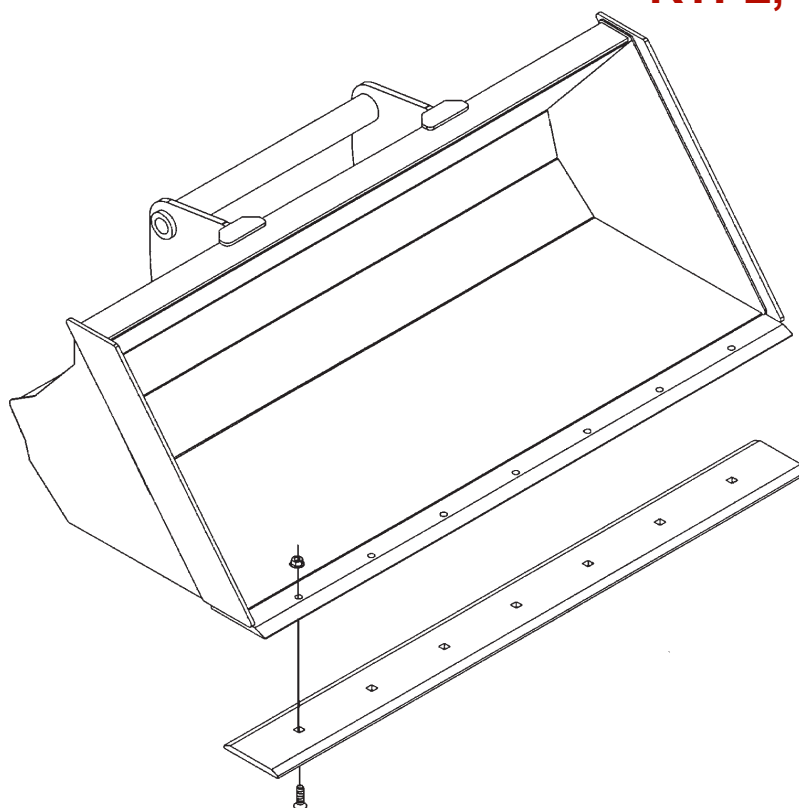

OPERATOR'S AND PARTS MANUAL

BUCKET
.50 - 1.00 CU. YD.

FOR
RTFL, TLB & WL



SERIAL NUMBER: _____

MODEL NUMBER: _____

Manual Number: 76836

Part Number: 76836

Rev. 3

TABLE OF CONTENTS

PREFACE.....	5
SAFETY STATEMENTS.....	6
GENERAL SAFETY PRECAUTIONS.....	6-8
EQUIPMENT SAFETY PRECAUTIONS.....	9-10
DECALS.....	11
INSTALLATION AND OPERATION.....	12
STORAGE.....	13
LIMITED WARRANTY	15
BUCKET ASSEMBLIES	16-41
.50 CUBIC YARD X 46" - ASSEMBLY #12747	16
.50 CUBIC YARD X 48" - ASSEMBLY #12632	17
.50 CUBIC YARD X 66" - ASSEMBLY #12683	18
.75 CUBIC YARD X 60" - ASSEMBLY #12541	19
.75 CUBIC YARD X 77" - ASSEMBLY #12804	20
.94 CUBIC YARD X 54" - ASSEMBLY #12924	21
1.00 CUBIC YARD X 60" - ASSEMBLY #12785	22
1.00 CUBIC YARD X 60" - ASSEMBLY #12787	23
1.00 CUBIC YARD X 60" - ASSEMBLY #13054	24
1.00 CUBIC YARD X 72" - ASSEMBLY #11058	25
1.00 CUBIC YARD X 72" - ASSEMBLY #12663	26
1.00 CUBIC YARD X 72" - ASSEMBLY #13133	27
1.00 CUBIC YARD X 77" - ASSEMBLY #12388	28
1.00 CUBIC YARD X 77" - ASSEMBLY #13162	29
1.00 CUBIC YARD X 80" - ASSEMBLY #12530	30
1.00 CUBIC YARD X 80" - ASSEMBLY #12649	31
1.00 CUBIC YARD X 80" - ASSEMBLY #12749	32
1.00 CUBIC YARD X 80" - ASSEMBLY #17282	33
1.00 CUBIC YARD X 80.7" - ASSEMBLY #12752	34
1.00 CUBIC YARD X 82" - ASSEMBLY #12571	35
1.00 CUBIC YARD X 84" - ASSEMBLY #12969	36
1.00 CUBIC YARD X 84" - ASSEMBLY #12986	37
1.00 CUBIC YARD X 85" - ASSEMBLY #12809	38
1.00 CUBIC YARD X 96" - ASSEMBLY #11036	39
1.00 CUBIC YARD X 96" - ASSEMBLY #12589	40
1.00 CUBIC YARD X 96" - ASSEMBLY #12968	41
CUTTING EDGE ASSEMBLIES	42-48
66" BOLT-ON ASSEMBLY #18682	42
72" BOLT-ON ASSEMBLY #12504	43
77" BOLT-ON ASSEMBLY #14989	44
80" BOLT-ON ASSEMBLY #309995	45
82" BOLT-ON ASSEMBLY #17718	46
85" BOLT-ON ASSEMBLY #12812	47
96" BOLT-ON ASSEMBLY #11002	48

FOREWORD

Although Bradco has various .50 to 1.00 cubic yard buckets available, we are continually designing new bucket sizes and mountings. If your combination is not listed, please contact the factory. We have extensive mounting information available to generate the product you need.

Below is a listing of the bucket assemblies available in the .50 to 1.00 cubic yard range that are shown in the "Parts" section of this manual.

DESCRIPTION & MOUNT	ASSEMBLY #
CASE	
1.00 Cubic Yard x 96.00" Bucket - CASE 640 (PRE-2002)	11036
1.00 Cubic Yard x 96.00" Bucket - CASE 688G	12968
CATERPILLAR	
.50 Cubic Yard x 46.00" Bucket - CAT 902/906/908	12747
.50 Cubic Yard x 66.00" Bucket - CAT 902/906/908	12683
1.00 Cubic Yard x 72.00" Bucket - CAT 902/906/908	12733
1.00 Cubic Yard x 80.00" Bucket - CAT IT/TH	12649
FURUKAWA	
.75 Cubic Yard x 72.00" Bucket - FURUKAWA With Universal Hitch	11058
INGERSOLL RAND	
1.00 Cubic Yard x 96.00" Bucket - IR 642 (PRE-2002)	11036
1.00 Cubic Yard x 96.00" Bucket - IR VR843	12968
JCB	
.50 Cubic Yard x 48.00" Bucket - JCB 520	12632
.50 Cubic Yard x 54.00" Bucket - JCB 407B	11015
.75 Cubic Yard x 77.00" Bucket - JCB 407ZX & 409	12804
1.00 Cubic Yard x 60.00" Bucket - JCB 408	12787
1.00 Cubic Yard x 68.00" Bucket - JCB 210SL Q-FIT	11047
1.00 Cubic Yard x 72.00" Bucket - JCB 407BZX/409BZX	12388
1.00 Cubic Yard x 72.00" Bucket - JCB 416 HT WHEEL LOADER	12663
1.00 Cubic Yard x 77.00" Bucket - JCB 409/SN #130-2000 & UP	13162
1.00 Cubic Yard x 80.00" Bucket - JCB 506/508	12749
1.00 Cubic Yard x 82.00" Bucket - JCB 520	12571
1.00 Cubic Yard x 84.00" Bucket - JCB 524 Low Profile Quick Attach	12969
1.00 Cubic Yard x 84.00" Bucket - JCB 524 With Universal Hitch	12986
1.00 Cubic Yard x 85.00" Bucket - JCB 407BZX/409BZX	11051
1.00 Cubic Yard x 85.00" Bucket - JCB Q-FIT	12809

DESCRIPTION & MOUNT	ASSEMBLY #
JCB	
1.00 Cubic Yard x 96.00" Bucket - JCB 506B/506C/508	11548
1.00 Cubic Yard x 96.00" Bucket - JCB 407BZX/407BZX	12315
1.00 Cubic Yard x 96.00" Bucket - JCB 526	12502
1.00 Cubic Yard x 96.00" Bucket - JCB 508B	12589
1.00 Cubic Yard x 96.00" Bucket - 411HT	13054
KOMATSU	
.50 Cubic Yard x 66.00" Bucket - KOMATSU WA 65/75/85/95	12546
LULL	
1.00 Cubic Yard x 96.00" Bucket - LULL 644E/944E	12589
MANITOU	
1.00 Cubic Yard x 80.00" Bucket - MANITOU	12530
1.00 Cubic Yard x 80.00" Bucket - MANITOU	12392
1.00 Cubic Yard x 80.00" Bucket - MANITOU	17282
NEW HOLLAND	
1.00 Cubic Yard x 60.00" Bucket - NH LW-80 Quick Attach	12785
1.00 Cubic Yard x 72.00" Bucket - NH LW-80 Quick Attach	12424
1.00 Cubic Yard x 83.00" Bucket - NH 45 TLB	307021
1.00 Cubic Yard x 83.00" Bucket - NH 445C/545D	307073
TRAK	
1.00 Cubic Yard x 80.00" Bucket - SKYTRAK Quick Attach	12749
1.00 Cubic Yard x 96.00" Bucket - SKYTRAK Quick Attach	12589
TEREX	
.75 Cubic Yard x 60.00" Bucket - TEREX 51-19 Terex Hitch	12541
1.00 Cubic Yard x 80.00" Bucket - TEREX With Quick Attach	12749
1.00 Cubic Yard x 80.7" Bucket - TEREX TX5119 Through 6622 W/Edge	12752
1.00 Cubic Yard x 96.00" Bucket - TEREX With Quick Attach	12589
UNIVERSAL HITCH	
1.00 Cubic Yard x 73" Bucket - Universal Hitch	13133
VOLVO	
.75 Cubic Yard x 77.00" Bucket - VOLVO L30-L35	12804
1.00 Cubic Yard x 60.00" Bucket - VOLVO L45	13054
1.00 Cubic Yard x 60.00" Bucket - VOLVO L30-L35	12787

**THIS PAGE
IS INTENTIONALLY
BLANK**

PREFACE

GENERAL COMMENTS

Congratulations on the purchase of your new attachment! This product was carefully designed and manufactured to give you many years of dependable service. Only minor maintenance (such as cleaning and lubricating) is required to keep it in top working condition. Be sure to observe all maintenance procedures and safety precautions in this manual and on any safety decals located on the product and on any equipment on which the attachment is mounted.

This manual has been designed to help you do a better, safer job. Read this manual carefully and become familiar with its contents.

WARNING! Never let anyone operate this unit without reading the "Safety Precautions" and "Operating Instructions" sections of this manual.



Always choose hard, level ground to park the vehicle on and set the brake so the unit cannot roll.

Unless noted otherwise, right and left sides are determined from the operator's control position when facing the attachment.

NOTE: The illustrations and data used in this manual were current (according to the information available to us) at the time of printing, however, we reserve the right to redesign and change the attachment as may be necessary without notification.

BEFORE OPERATION

The primary responsibility for safety with this equipment falls to the operator. Make sure the equipment is operated only by trained individuals that have read and understand this manual. If there is any portion of this manual or function you do not understand, contact your local authorized dealer or the manufacturer to obtain further assistance. Keep this manual available for reference. Provide the manual to any new owners and/or operators.

SAFETY ALERT SYMBOL



This is the "Safety Alert Symbol" used by this industry. This symbol is used to warn of possible injury. Be sure to read all warnings carefully. They are included for your safety and for the safety of others working with you.

SERVICE

Use only manufacturer replacement parts. Substitute parts may not meet the required standards.

Record the model and serial number of your unit on the cover of this manual. The parts department needs this information to insure that you receive the correct parts.

SOUND AND VIBRATION

Sound pressure levels and vibration data for this attachment are influenced by many different parameters: some items are listed below (not inclusive):

- prime mover type, age, condition, with or without cab enclosure and configuration
- operator training, behavior, stress level
- job site organization, working material condition, environment

Based on the uncertainty of the prime mover, operator, and job site, it is not possible to get precise machine and operator sound pressure levels or vibration levels for this attachment.

NOTE: A list of all Paladin Patents can be found at <http://www.paladinattachments.com/patents.asp>.

M-934 10-22-13-5

SAFETY STATEMENTS



THIS SYMBOL BY ITSELF OR WITH A WARNING WORD THROUGHOUT THIS MANUAL IS USED TO CALL YOUR ATTENTION TO INSTRUCTIONS INVOLVING YOUR PERSONAL SAFETY OR THE SAFETY OF OTHERS. FAILURE TO FOLLOW THESE INSTRUCTIONS CAN RESULT IN INJURY OR DEATH.



DANGER

THIS SIGNAL WORD INDICATES A HAZARDOUS SITUATION WHICH, IF NOT AVOIDED, WILL RESULT IN DEATH OR SERIOUS INJURY.



WARNING

THIS SIGNAL WORD INDICATES A HAZARDOUS SITUATION WHICH, IF NOT AVOIDED, COULD RESULT IN DEATH OR SERIOUS INJURY.



CAUTION

THIS SIGNAL WORD INDICATES A HAZARDOUS SITUATION WHICH, IF NOT AVOIDED, COULD RESULT IN MINOR OR MODERATE INJURY.

NOTICE

NOTICE IS USED TO ADDRESS PRACTICES NOT RELATED TO PHYSICAL INJURY.

GENERAL SAFETY PRECAUTIONS

WARNING!



READ MANUAL PRIOR TO INSTALLATION

Improper installation, operation, or maintenance of this equipment could result in serious injury or death. Operators and maintenance personnel should read this manual, as well as all manuals related to this equipment and the prime mover thoroughly before beginning installation, operation, or maintenance. **FOLLOW ALL SAFETY INSTRUCTIONS IN THIS MANUAL AND THE PRIME MOVER'S MANUAL(S).**



READ AND UNDERSTAND ALL SAFETY STATEMENTS

Read all safety decals and safety statements in all manuals prior to operating or working on this equipment. Know and obey all OSHA regulations, local laws, and other professional guidelines for your operation. Know and follow good work practices when assembling, maintaining, repairing, mounting, removing, or operating this equipment.



KNOW YOUR EQUIPMENT

Know your equipment's capabilities, dimensions, and operations before operating. Visually inspect your equipment before you start, and never operate equipment that is not in proper working order with all safety devices intact. Check all hardware to ensure it is tight. Make certain that all locking pins, latches, and connection devices are properly installed and secured. Remove and replace any damaged, fatigued, or excessively worn parts. Make certain all safety decals are in place and are legible. Keep decals clean, and replace them if they become worn or hard to read.

GENERAL SAFETY PRECAUTIONS

WARNING!



PROTECT AGAINST FLYING DEBRIS

Always wear proper safety glasses, goggles, or a face shield when driving pins in or out, or when any operation causes dust, flying debris, or any other hazardous material.

WARNING!



LOWER OR SUPPORT RAISED EQUIPMENT

Do not work under raised booms without supporting them. Do not use support material made of concrete blocks, logs, buckets, barrels, or any other material that could suddenly collapse or shift positions. Make sure support material is solid, not decayed, warped, twisted, or tapered. Lower booms to ground level or on blocks. Lower booms and attachments to the ground before leaving the cab or operator's station.

WARNING!



USE CARE WITH HYDRAULIC FLUID PRESSURE

Hydraulic fluid under pressure can penetrate the skin and cause serious injury or death. Hydraulic leaks under pressure may not be visible. Before connecting or disconnecting hydraulic hoses, read your prime mover's operator's manual for detailed instructions on connecting and disconnecting hydraulic hoses or fittings.

- Keep unprotected body parts, such as face, eyes, and arms as far away as possible from a suspected leak. Flesh injected with hydraulic fluid may develop gangrene or other permanent disabilities.
- If injured by injected fluid, see a doctor at once. If your doctor is not familiar with this type of injury, ask him or her to research it immediately to determine proper treatment.
- Wear safety glasses, protective clothing, and use a piece of cardboard or wood when searching for hydraulic leaks. **DO NOT USE YOUR HANDS! SEE ILLUSTRATION.**

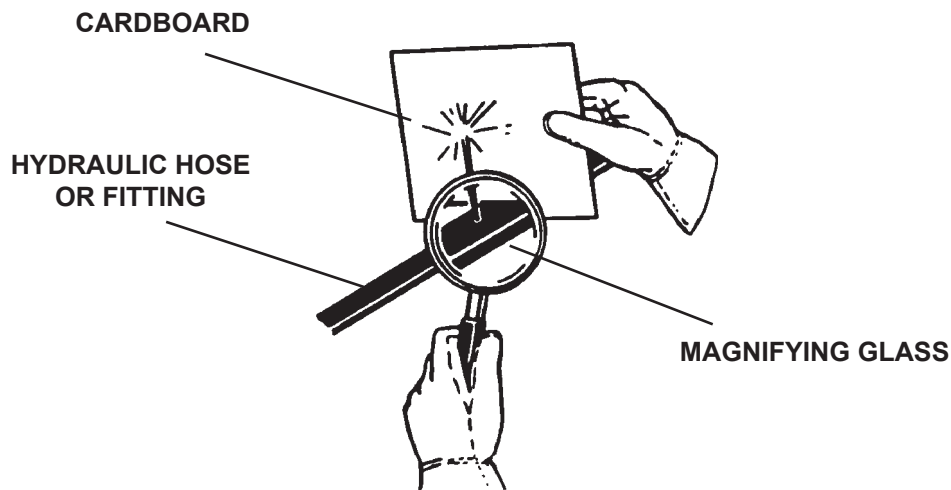

GENERAL SAFETY PRECAUTIONS

WARNING!



DO NOT MODIFY MACHINE OR ATTACHMENTS

Modifications may weaken the integrity of the attachment and may impair the function, safety, life, and performance of the attachment. When making repairs, use only the manufacturer's genuine parts, following authorized instructions. Other parts may be substandard in fit and quality. Never modify any ROPS (Roll Over Protection Structure) or FOPS (Falling Object Protective Structure) equipment or device. Any modifications must be authorized in writing by the manufacturer.

WARNING!



SAFELY MAINTAIN AND REPAIR EQUIPMENT

- Do not wear loose clothing or any accessories that can catch in moving parts. If you have long hair, cover or secure it so that it does not become entangled in the equipment.
- Work on a level surface in a well-lit area.
- Use properly grounded electrical outlets and tools.
- Use the correct tools for the job at hand. Make sure they are in good condition for the task required.
- Wear the protective equipment specified by the tool manufacturer.



SAFELY OPERATE EQUIPMENT

Do not operate equipment until you are completely trained by a qualified operator in how to use the controls, know its capabilities, dimensions, and all safety requirements. See your machine's manual for these instructions.

- Keep all step plates, grab bars, pedals, and controls free of dirt, grease, debris, and oil.
- Never allow anyone to be around the equipment when it is operating.
- Do not allow riders on the attachment or the prime mover.
- Do not operate the equipment from anywhere other than the correct operator's position.
- Never leave equipment unattended with the engine running, or with this attachment in a raised position.
- Do not alter or remove any safety feature from the prime mover or this attachment.
- Know your work site safety rules as well as traffic rules and flow. When in doubt on any safety issue, contact your supervisor or safety coordinator for an explanation.

WARNING!



CALIFORNIA PROPOSITION 65 WARNING

This product may contain a chemical known to the state of California to cause cancer, or birth defects or other reproductive harm. www.P65Warnings.ca.gov

EQUIPMENT SAFETY PRECAUTIONS

WARNING!



KNOW WHERE UTILITIES ARE

Observe overhead electrical and other utility lines. Be sure equipment will clear them. Electrocutation could occur if equipment contacts or damage overhead electrical lines. When digging, call your local utilities for location of buried utility lines, gas, water, and sewer, as well as any other hazard you may encounter.

WARNING!



EXPOSURE TO RESPIRABLE CRYSTALLINE SILICA DUST ALONG WITH OTHER HAZARDOUS DUSTS MAY CAUSE SERIOUS OR FATAL RESPIRATORY DISEASE.

It is recommended to use dust suppression, dust collection and if necessary personal protective equipment during the operation of any attachment that may cause high levels of dust.

WARNING!



REMOVE PAINT BEFORE WELDING OR HEATING

Hazardous fumes/dust can be generated when paint is heated by welding, soldering or using a torch. Do all work outside or in a well ventilated area, and dispose of paint and solvent properly. Remove paint before welding or heating.

When sanding or grinding paint, avoid breathing the dust. Wear an approved respirator. If you use solvent or paint stripper, remove stripper with soap and water before welding. Remove solvent or paint stripper containers and other flammable material from area. Allow fumes to disperse at least 15 minutes before welding or heating.

WARNING!



OPERATING THE PRIME MOVER

Avoid steep hillside operation, which could cause the prime mover to overturn. Consult your prime mover's operator's and safety manuals for maximum incline allowable. Extreme caution should be used when working along the top of banks or slopes. Keep away from the edge.

When operating on a slope, keep the load low, and proceed with extreme caution. Do not drive ACROSS a steep slope - drive straight up and down. With a LOADED bucket - face the bucket and load uphill.

With an EMPTY bucket - face the bucket downhill.



WORKING WITH THE ATTACHMENT

- Never use your attachment for a work platform or personnel carrier.
- Specified lift capacities must not be exceeded, otherwise machine stability is not sufficient. Always observe lift capacity limits listed in machine specifications or written on load charts.
- An operator must not use drugs or alcohol, which can change his or her alertness or coordination. An operator taking prescription or over-the-counter drugs should seek medical advice on whether or not he or she can safely operate equipment.
- Always check locking pins before operating any attachment.
- Never lift, move, or swing a loaded bucket over anyone.
- Never undercut a high bank. When working at the base of a bank, overhang, or stockpile, avoid dangers such as rock or earth slides, overhanging trees, or a cave-in, by proper job operation.
- Be careful when handling loose objects. Lifting too high, or rolling the bucket too far back, could result in these objects sliding backward down the arms onto the operator compartment.
- Don't obstruct your vision when traveling or working. Carry the bucket low for maximum stability and visibility.

M-1058 2-20-09-2

EQUIPMENT SAFETY PRECAUTIONS



TRANSPORTING THE ATTACHMENT

- When driving on public roads use safety lights, reflectors, Slow Moving Vehicle signs etc., to prevent accidents. Check local government regulations that may affect you.
- Do not drive close to ditches, excavations, etc., as a cave-in could result.
- Do not smoke when refueling the prime mover. Allow room in the fuel tank for expansion. Wipe up any spilled fuel. Secure cap tightly when done.
- When transporting, keep the attachment as low as the terrain will allow.



MAINTAINING THE ATTACHMENT

- Before performing maintenance, lower the attachment to the ground, apply the brakes, turn off the engine, and remove the key.
- Never perform any work on the attachment unless you are authorized and qualified to do so. Always read the operator service manuals before any repair is made. After completing maintenance or repair, check for correct functioning of the attachment. If not functioning properly, always tag “DO NOT OPERATE” until all problems are corrected.
- Worn, damaged, or illegible safety decals must be replaced. New safety decals can be ordered from BRADCO.
- Never make hydraulic repairs while the system is under pressure. Serious personal injury or death could result.
- Never work under a raised attachment.
- Replace all safety shields and guards (including the push bar) when done performing maintenance. Do not operate the attachment with protective equipment removed.

DECALS

GENERAL INFORMATION

The diagram on this page shows a reduction of the actual decal on the Bradco buckets in this manual. The decal is identified by its part number. Use this information to order replacements for lost or damaged decals. Be sure to read all decals before operating the attachment. They contain information you need to know for both safety and attachment longevity. All logos and model numbers can be purchased from your local dealer.

IMPORTANT: Keep all safety decals clean and legible. Replace all missing, illegible, or damaged safety decals. When replacing parts with safety decals attached, the safety decals must also be replaced.

REPLACING SAFETY DECALS: Clean the area of application with a nonflammable solvent, then wash the same area with soap and water. Allow the surface to dry. Remove the backing from the safety decal, exposing the adhesive surface. Apply the safety decal to the appropriate position, and smooth out any bubbles.



PART #4338
MADE IN U.S.A.

Logo decals can be purchased from your local dealer.

INSTALLATION AND OPERATION

ATTACHING AND DETACHING EQUIPMENT

Please see your vehicle operator's manual for instructions on attaching and detaching your equipment.

OPERATING EQUIPMENT

Read all Safety Precautions before operating your new attachment. If you have not been supplied with a load chart for your attachment, order one from your dealer, and place it inside the operating machine for safe lift capacity limits.

Refer to your machine operator's manual for attachment operation.

NOTE: A cutting edge assembly is recommended when operating on hard abrasive surfaces.

STORAGE

GENERAL INFORMATION

The following storage procedure will help you to keep your attachment in top condition. It will also help you get off to a good start the next time your equipment is needed. We therefore strongly recommend that you take the extra time to follow these procedures whenever your attachment will not be used for an extended period of time.

PREPARATION FOR STORAGE

1. Clean the attachment thoroughly, removing all mud, dirt, and grease.
2. Inspect for visible signs of wear, breakage, or damage. Order any parts required, and make the necessary repairs, to avoid delays when starting next season.
3. Tighten all loose nuts and capscrews.
4. Touch up all unpainted and exposed areas with paint, to prevent rust.
5. Replace decals, if damaged or in unreadable condition.
6. Store the attachment in a dry and protected place, with a cover, if possible. Leaving the attachment outside will materially shorten its life.

REMOVING FROM STORAGE

1. Remove all protective coverings.

**THIS PAGE
IS INTENTIONALLY
BLANK**

LIMITED WARRANTY

In order to provide you with the most UP-TO-DATE Warranty information, Paladin Warranty Statement and Warranty Procedures along with Warranty Registration and Claim Forms have been moved to our website at www.paladinattachments.com.

GENERAL PURPOSE BUCKET

ASSEMBLY #12747

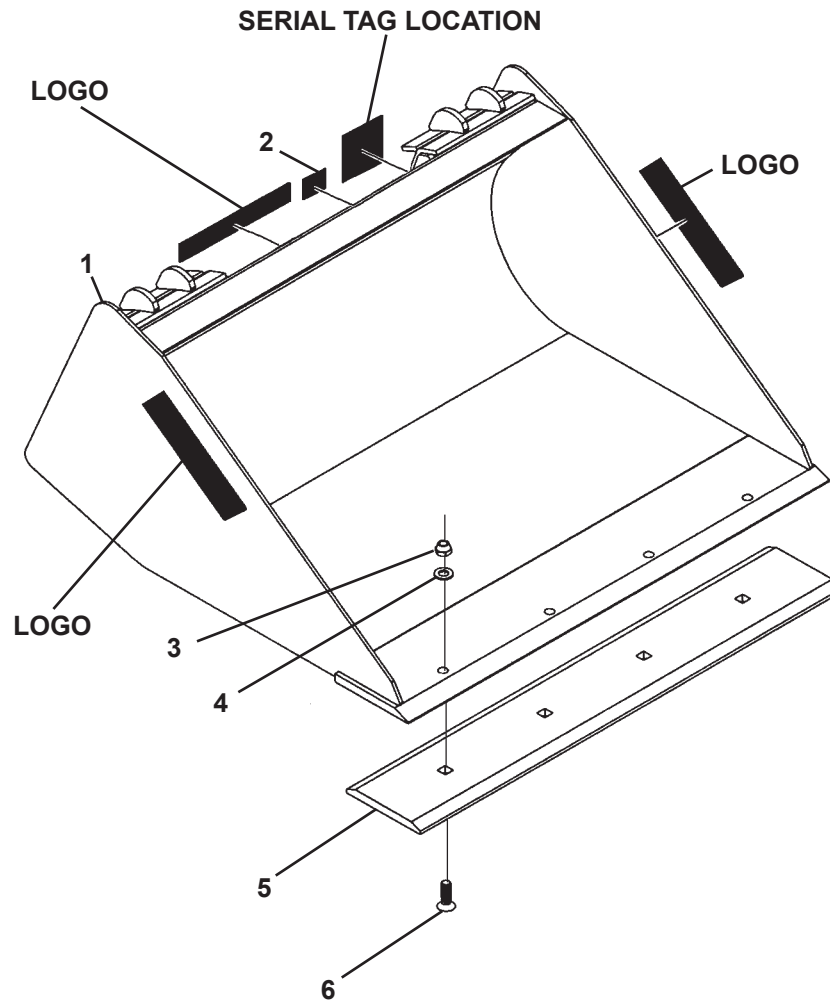

<u>ITEM</u>	<u>QTY</u>	<u>PART NO.</u>	<u>DESCRIPTION</u>
1	1	102932	Bucket, .50 Cubic Yard x 46" Wide
2	1	4338	Made in USA Decal
3	4	1936	.75" UNC Deformed Lock Nut
4	4	1649	.75" Hard Flat Washer
5	1	102989	Cutting Edge, .75" x 8.00" x 46.00"
6	4	10061	.75" UNC x 2.25" Plow Bolt

M-999 2-24-09-2

GENERAL PURPOSE BUCKET

ASSEMBLY #12632

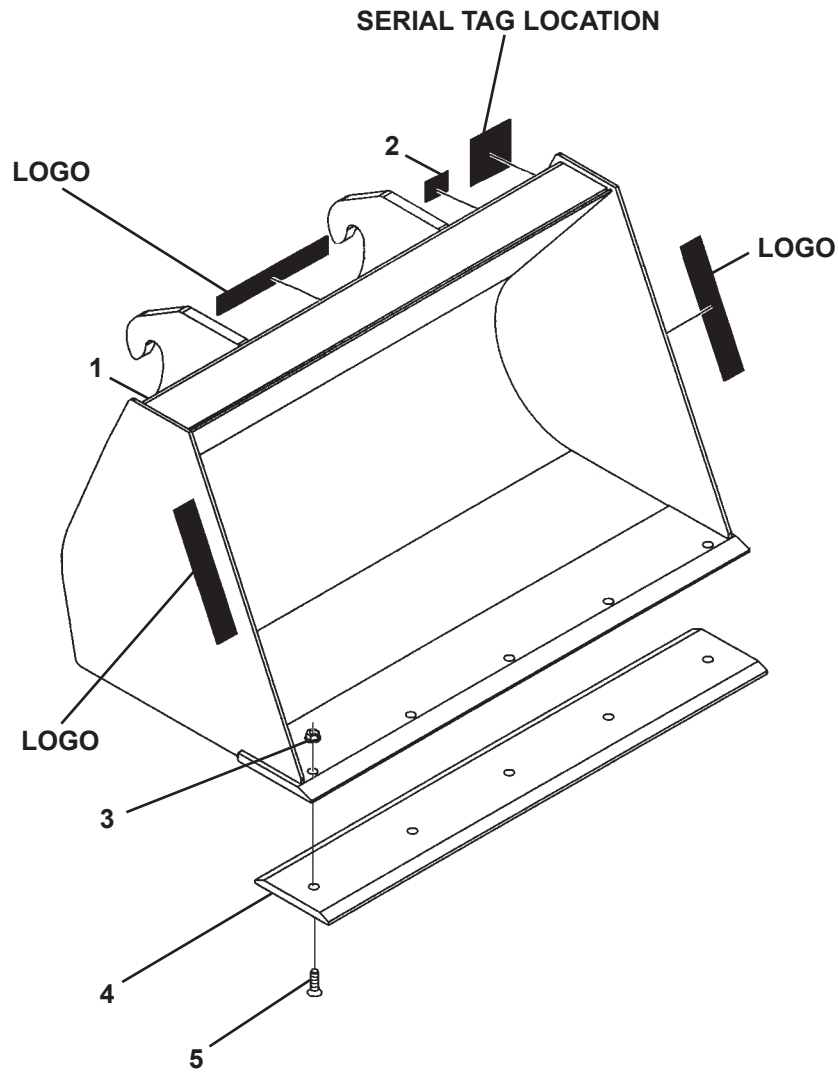

<u>ITEM</u>	<u>QTY</u>	<u>PART NO.</u>	<u>DESCRIPTION</u>
1	1	104550	Bucket, .50 Cubic Yard x 48" Wide
2	1	4338	Made in USA Decal
3	5	1936	.75" UNC Deformed Lock Nut
4	1	317439	Cutting Edge, .75" x 8.00" x 48.06"
5	5	1937	.75" UNC x 2.50" Plow Bolt

M-1001 2-24-09-2

GENERAL PURPOSE BUCKET

ASSEMBLY #12683

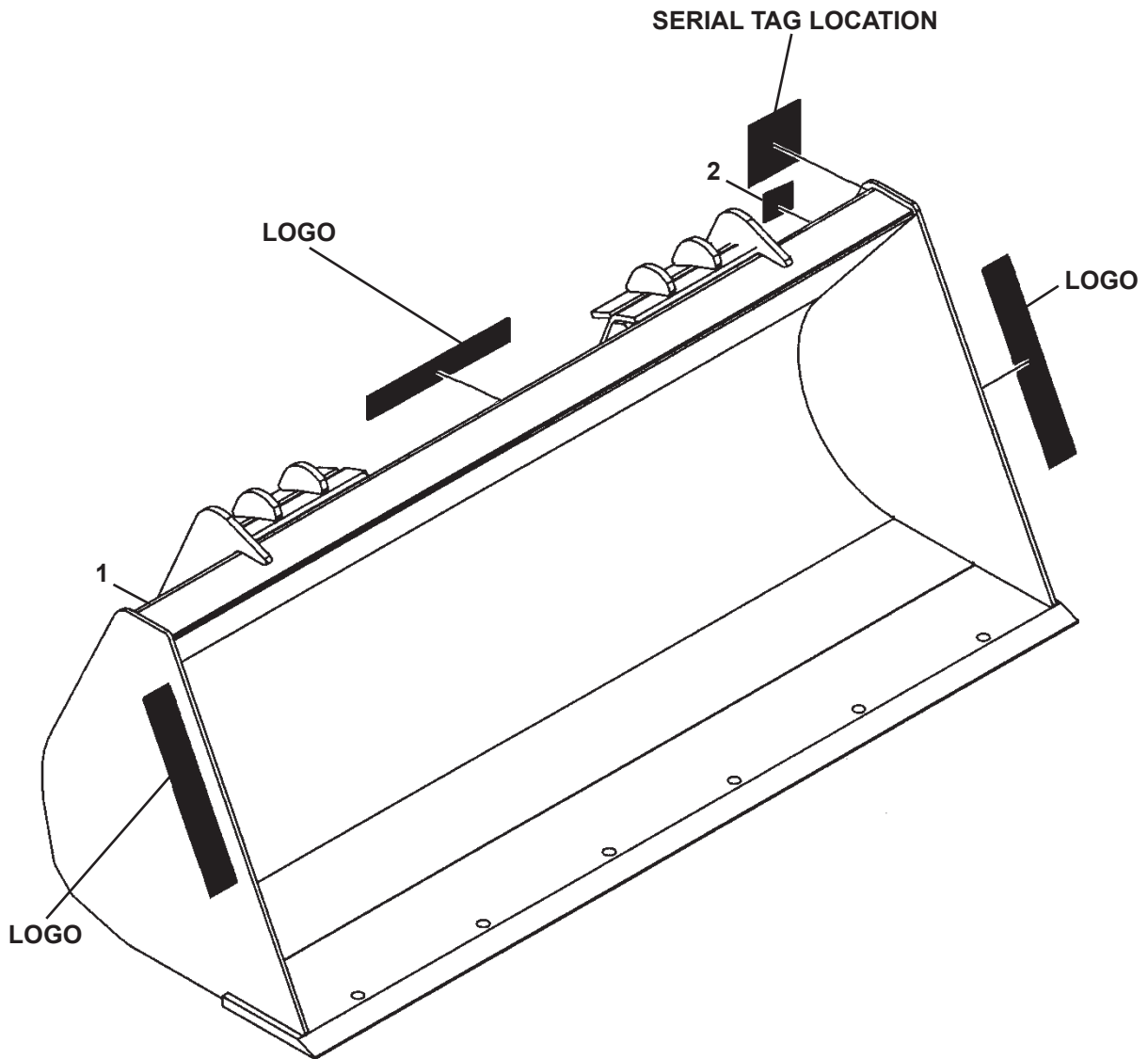

<u>ITEM</u>	<u>QTY</u>	<u>PART NO.</u>	<u>DESCRIPTION</u>
1	1	101586	Bucket, .50 Cubic Yard x 66" Wide
2	1	4338	Made in USA Decal

NOTE: Optional cutting edge assembly #18682 is available for this bucket.

M-907 2-24-09-2

GENERAL PURPOSE BUCKET

ASSEMBLY #12541

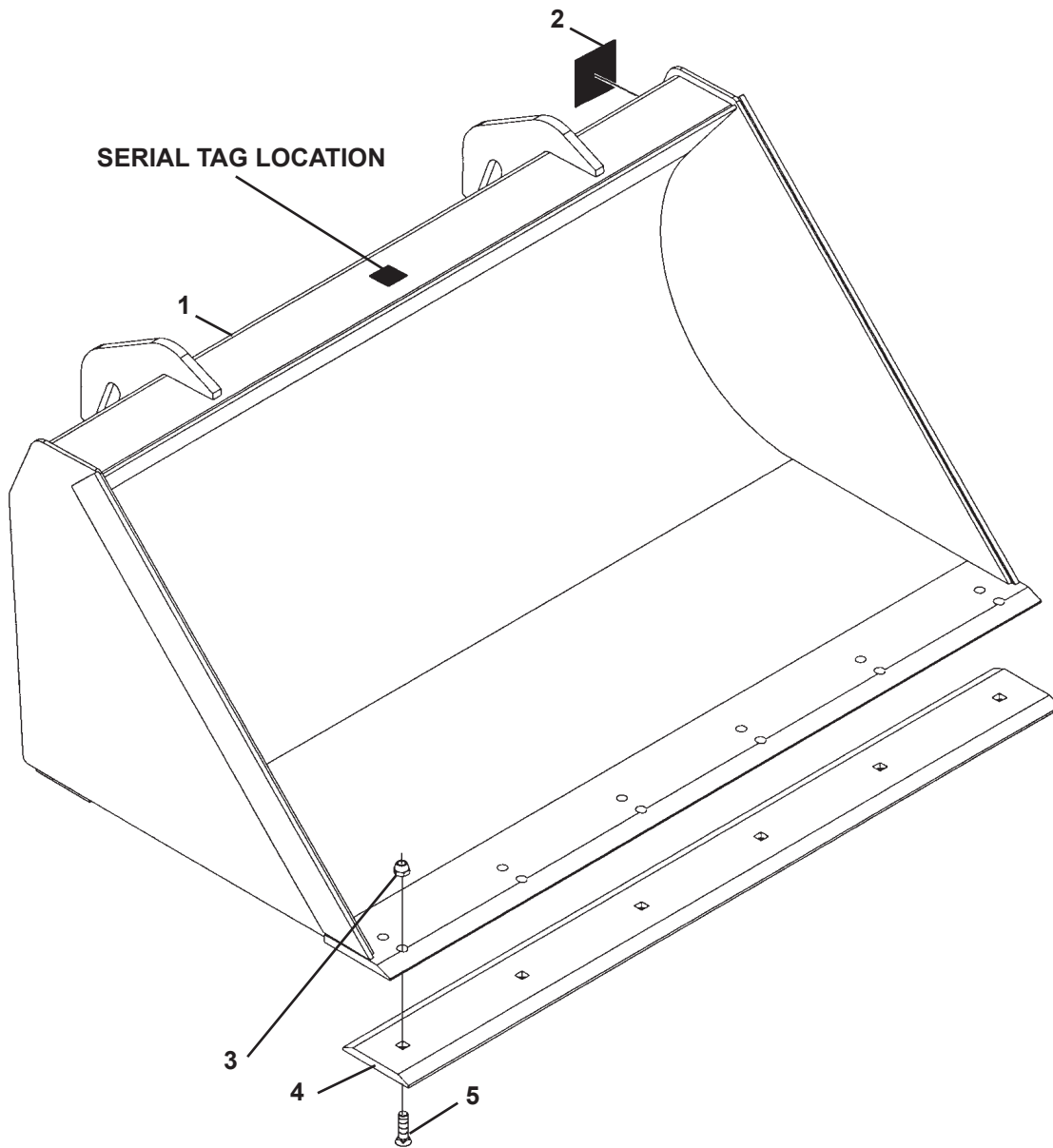

<u>ITEM</u>	<u>QTY</u>	<u>PART NO.</u>	<u>DESCRIPTION</u>
1	1	19121	Bucket, .75 Cubic Yard x 60" Wide
2	1	4338	Made in USA Decal
3	6	1839	.62" UNC Deformed Lock Nut
4	1	32881	Bolt-On Cutting Edge, .63" x 6.00" x 60.00"
5	6	10022	.62" UNC x 2.25" Plow Bolt

M-2171 3-16-09

ASSEMBLY #12804

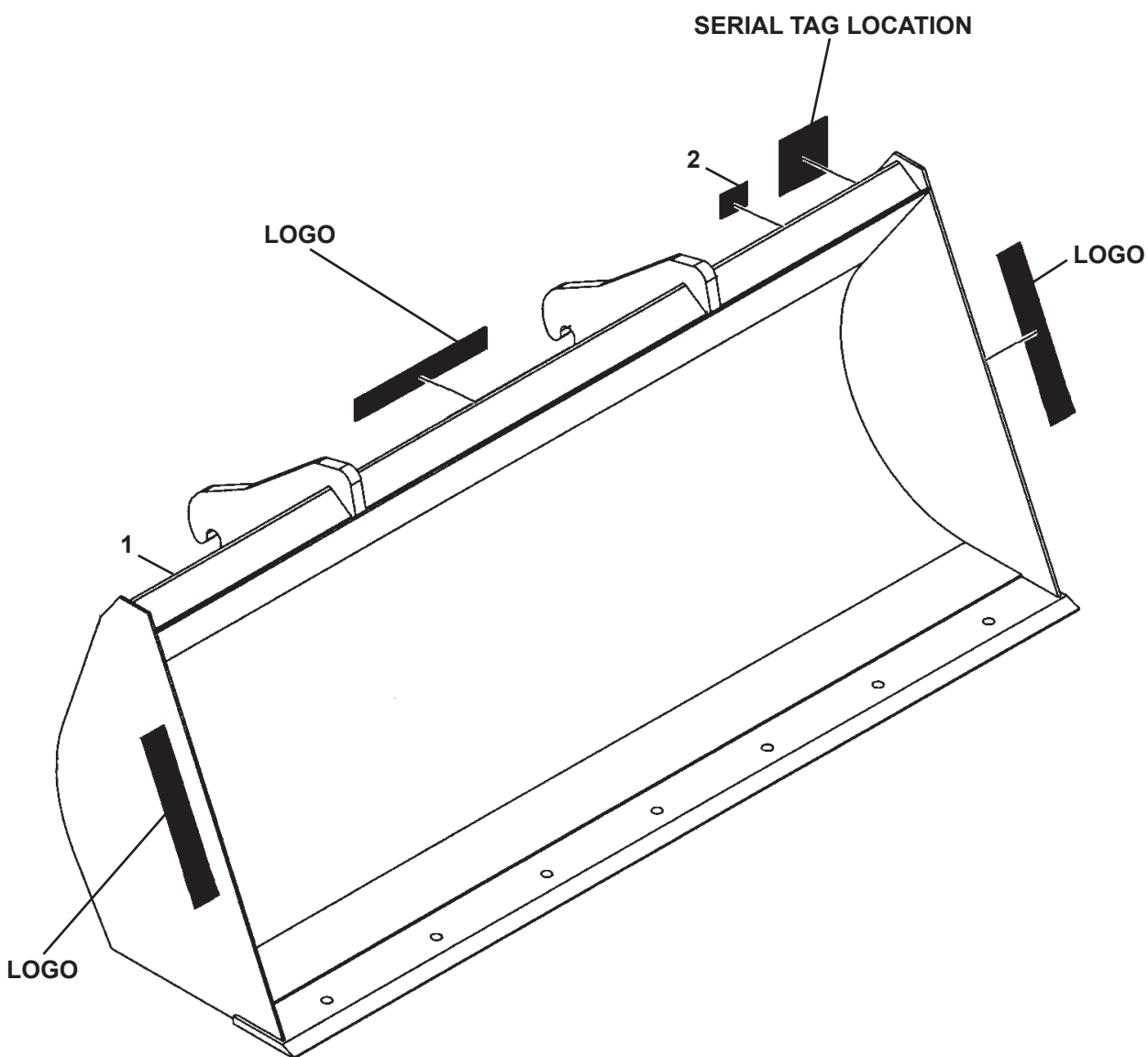

<u>ITEM</u>	<u>QTY</u>	<u>PART NO.</u>	<u>DESCRIPTION</u>
1	1	104750	Bucket, .75 Cubic Yard x 77" Wide
2	1	4338	Made in USA Decal

NOTE: Optional cutting edge assembly #14989 is available for this bucket.

GENERAL PURPOSE BUCKET

ASSEMBLY #12924

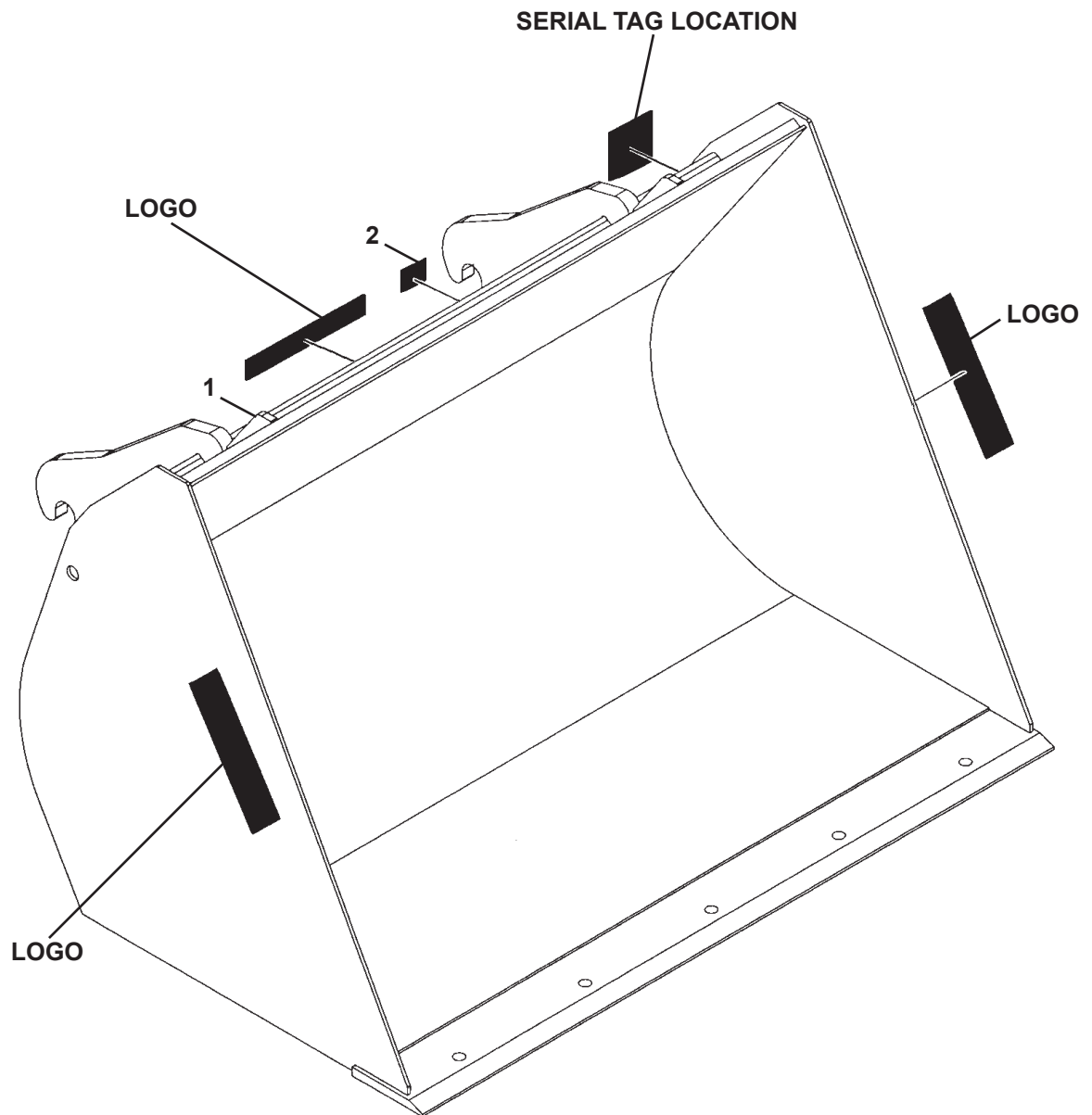

<u>ITEM</u>	<u>QTY</u>	<u>PART NO.</u>	<u>DESCRIPTION</u>
1	1	106893	Bucket, .94 Cubic Yard x 54" Wide
2	1	4338	Made in USA Decal

M-2139 2-24-09

GENERAL PURPOSE BUCKET

ASSEMBLY #12785

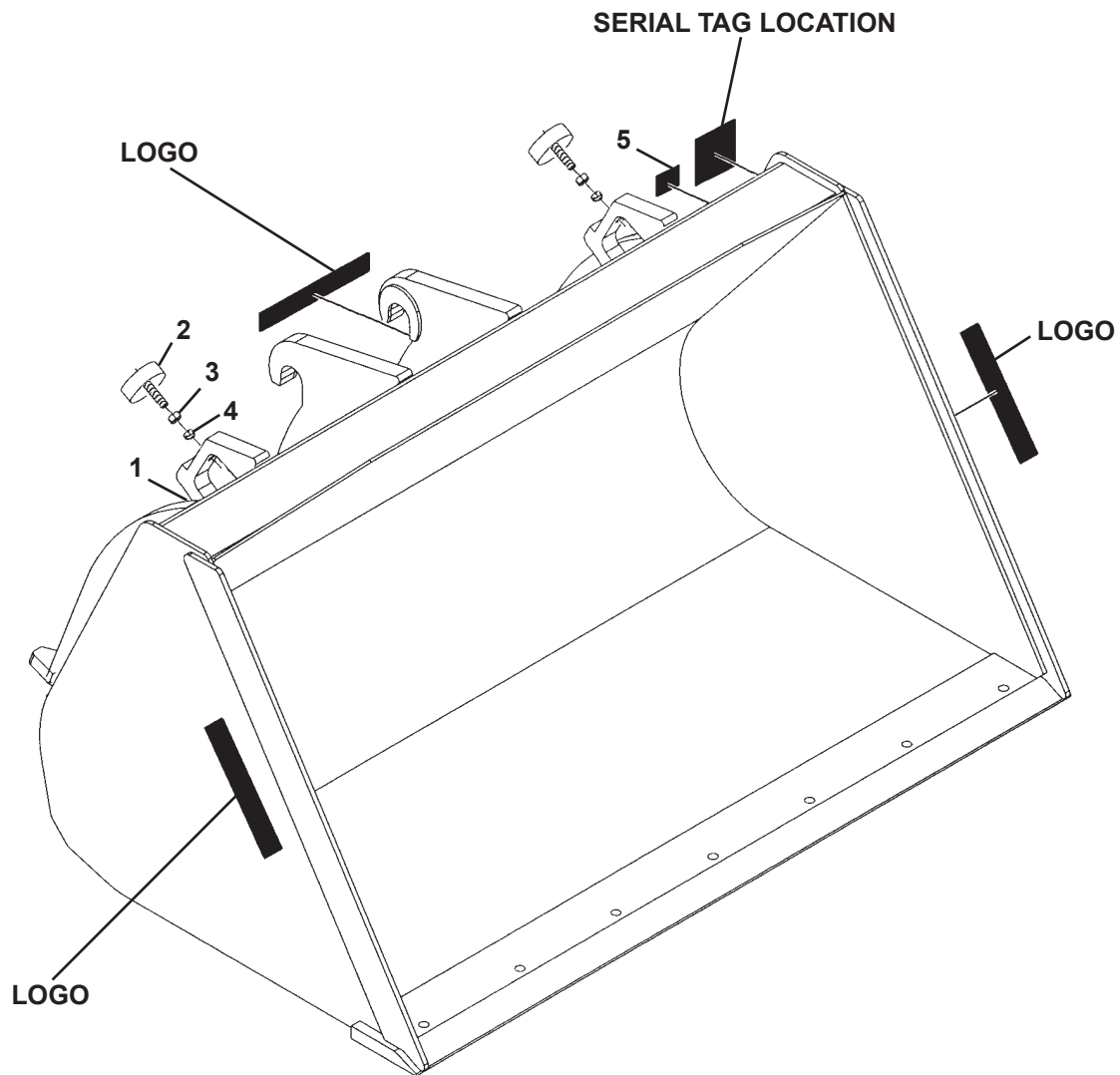

<u>ITEM</u>	<u>QTY</u>	<u>PART NO.</u>	<u>DESCRIPTION</u>
1	1	104382	Bucket, 1.00 Cubic Yard x 60" Wide
2	2	308688	Rollback Bumper
3	2	2533	Lock Washer, 12MM
4	2	2560	M12 Hex Nut
5	1	4338	Made in USA Decal

M-2137 2-24-09

GENERAL PURPOSE BUCKET

ASSEMBLY #12787

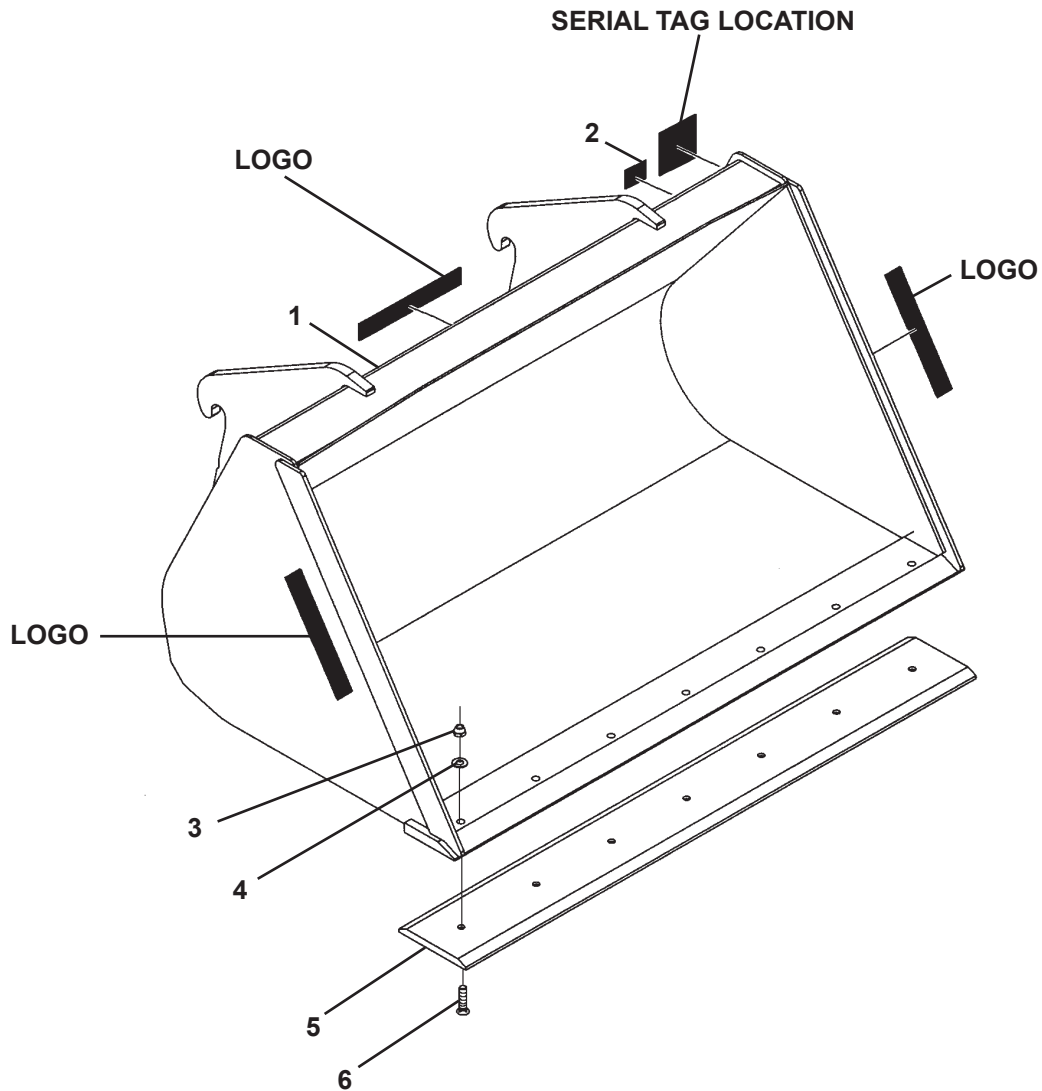

<u>ITEM</u>	<u>QTY</u>	<u>PART NO.</u>	<u>DESCRIPTION</u>
1	1	104302	Bucket, 100 Cubic Yard x 60" Wide
2	1	4338	Made in USA Decal
3	7	1839	.62" UNC Deformed Lock Nut
4	7	1627	.62" Hard Flat Washer
5	1	15094	Cutting Edge, .75" x 8.00" x 61.00"
6	7	10021	.75" UNC x 2.50" Plow Bolt, Grade 8

M-1003 2-25-09-2

GENERAL PURPOSE BUCKET

ASSEMBLY #13054

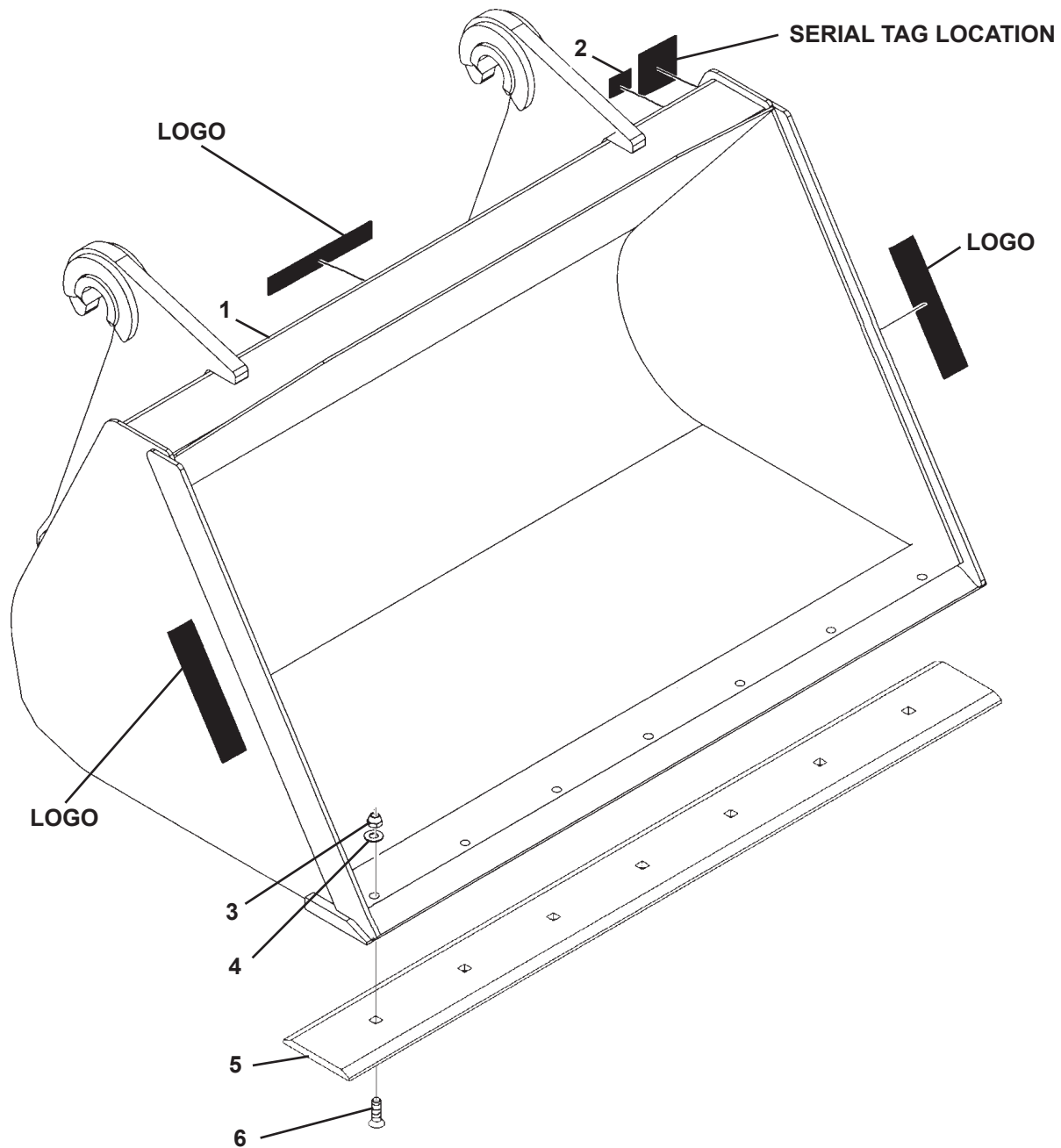

<u>ITEM</u>	<u>QTY</u>	<u>PART NO.</u>	<u>DESCRIPTION</u>
1	1	110250	Bucket, 1.00 Cubic Yard x 60" Wide
2	1	4338	Made in USA Decal
3	7	1839	.62" UNC Deformed Lock Nut
4	7	1627	.62" Hard Flat Washer
5	1	15094	Cutting Edge, .75" x 8.00" x 61.00"
6	7	10021	.62" UNC x 2.50" Plow Bolt, Grade 8

M-2136 2-24-09

GENERAL PURPOSE BUCKET

ASSEMBLY #11058

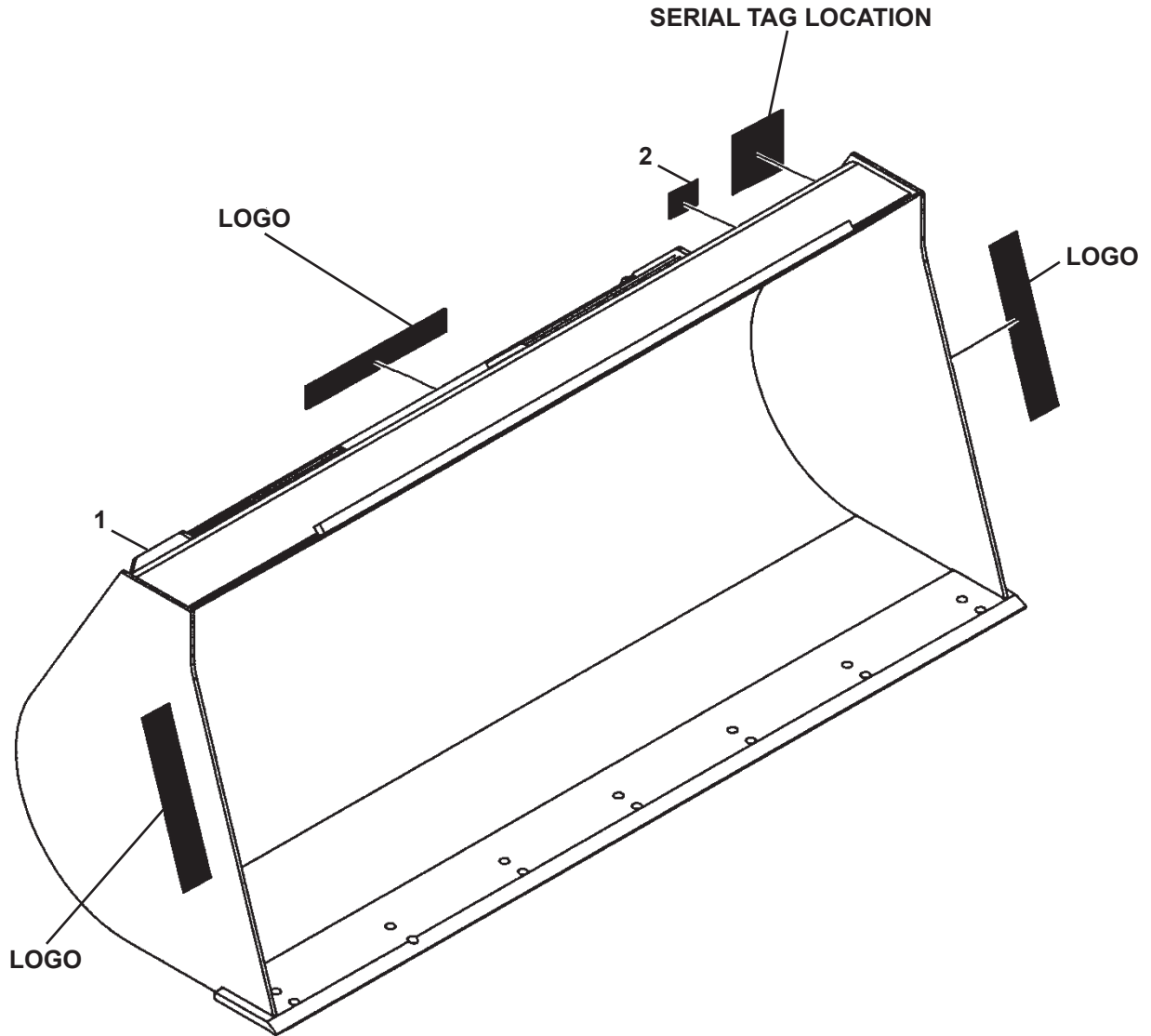

<u>ITEM</u>	<u>QTY</u>	<u>PART NO.</u>	<u>DESCRIPTION</u>
1	1	18590	Bucket, 1.00 Cubic Yard x 72" Wide
2	1	4338	Made in USA Decal

NOTE: Optional cutting edge assembly #12504 is available for this bucket.

M-990 2-24-09-2

GENERAL PURPOSE BUCKET

ASSEMBLY #12663

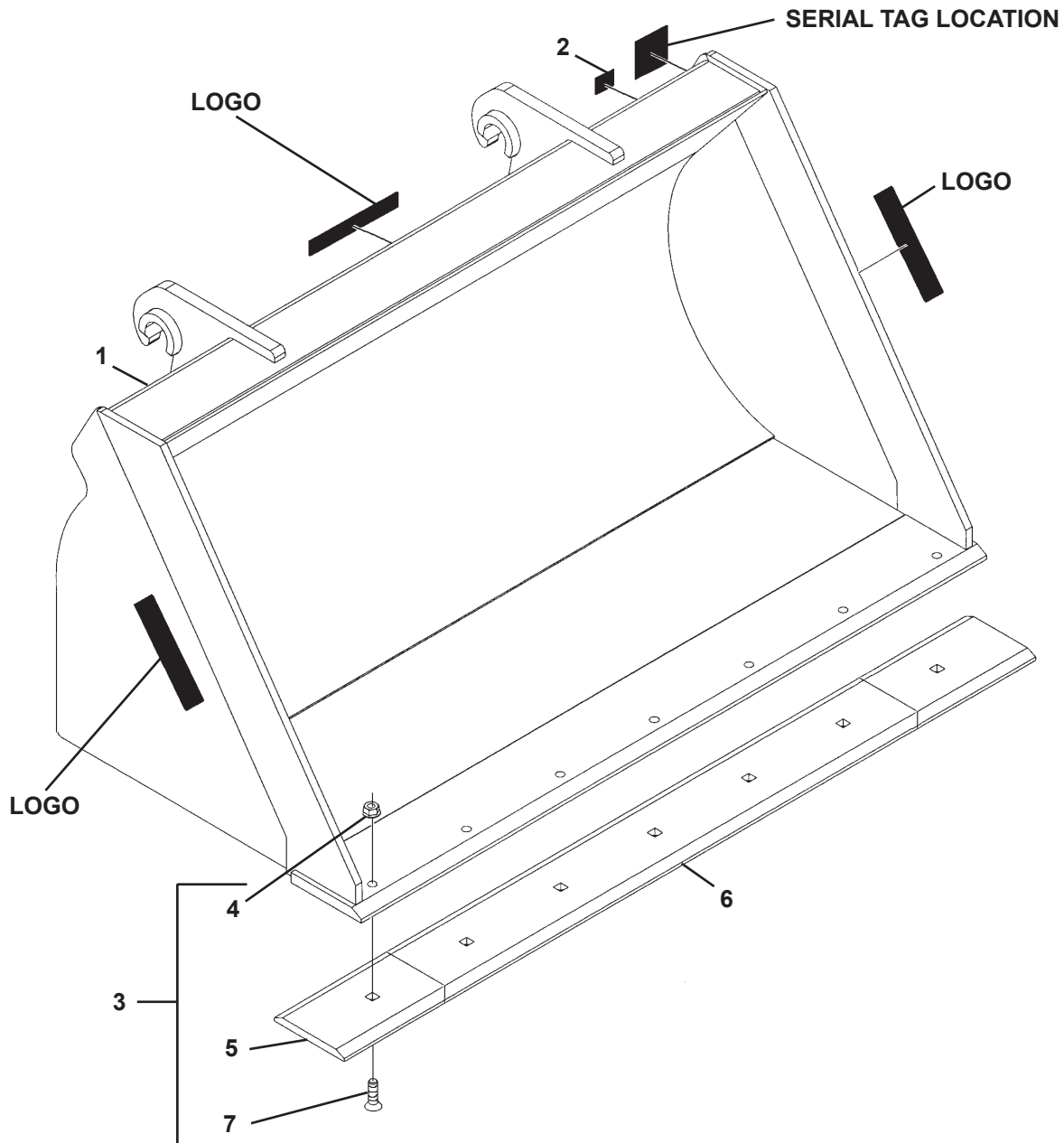

<u>ITEM</u>	<u>QTY</u>	<u>PART NO.</u>	<u>DESCRIPTION</u>
1	1	318869	Bucket, 1.00 Cubic Yard x 72" Wide
2	1	4338	Made in USA Decal
3	1	309610	Bolt-On Cutting Edge Assembly (Includes Items 4-7)
4	7	1936	.75" UNC Deformed Lock Nut
5	2	309609	Cutting Edge, .75" x 8.00" x 17.87"
6	1	309608	Cutting Edge, .75" x 8.00" x 36.27"
7	7	1937	.75" UNC x 2.50" Plow Bolt

M-2138 2-24-09

GENERAL PURPOSE BUCKET

ASSEMBLY #13133

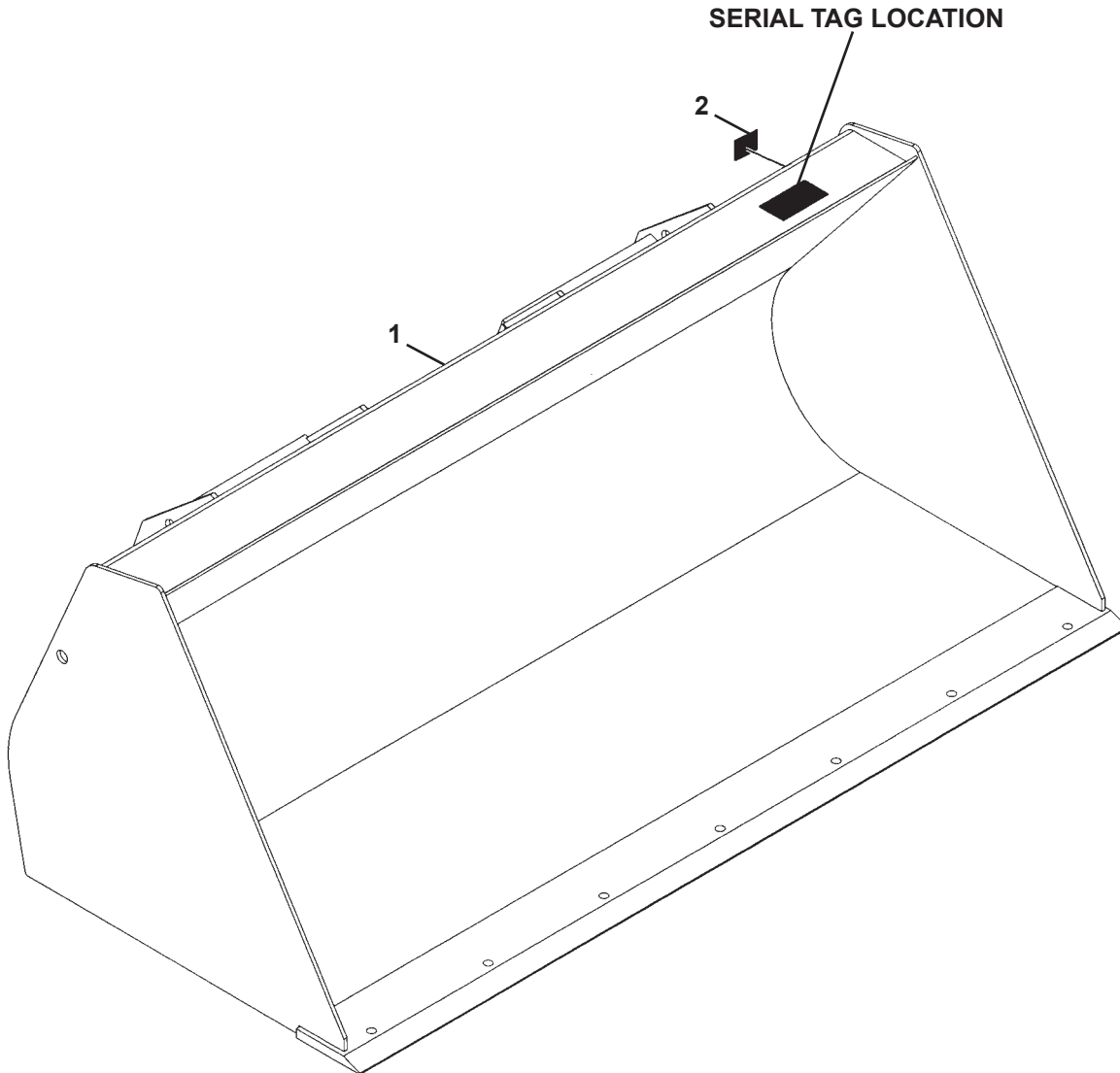

<u>ITEM</u>	<u>QTY</u>	<u>PART NO.</u>	<u>DESCRIPTION</u>
1	1	112483	Bucket, 1.00 Cubic Yard x 72" Wide
2	1	4338	Made in USA Decal

NOTE: Optional cutting edge assembly #15028 is available for this bucket.

GENERAL PURPOSE BUCKET

ASSEMBLY #12388

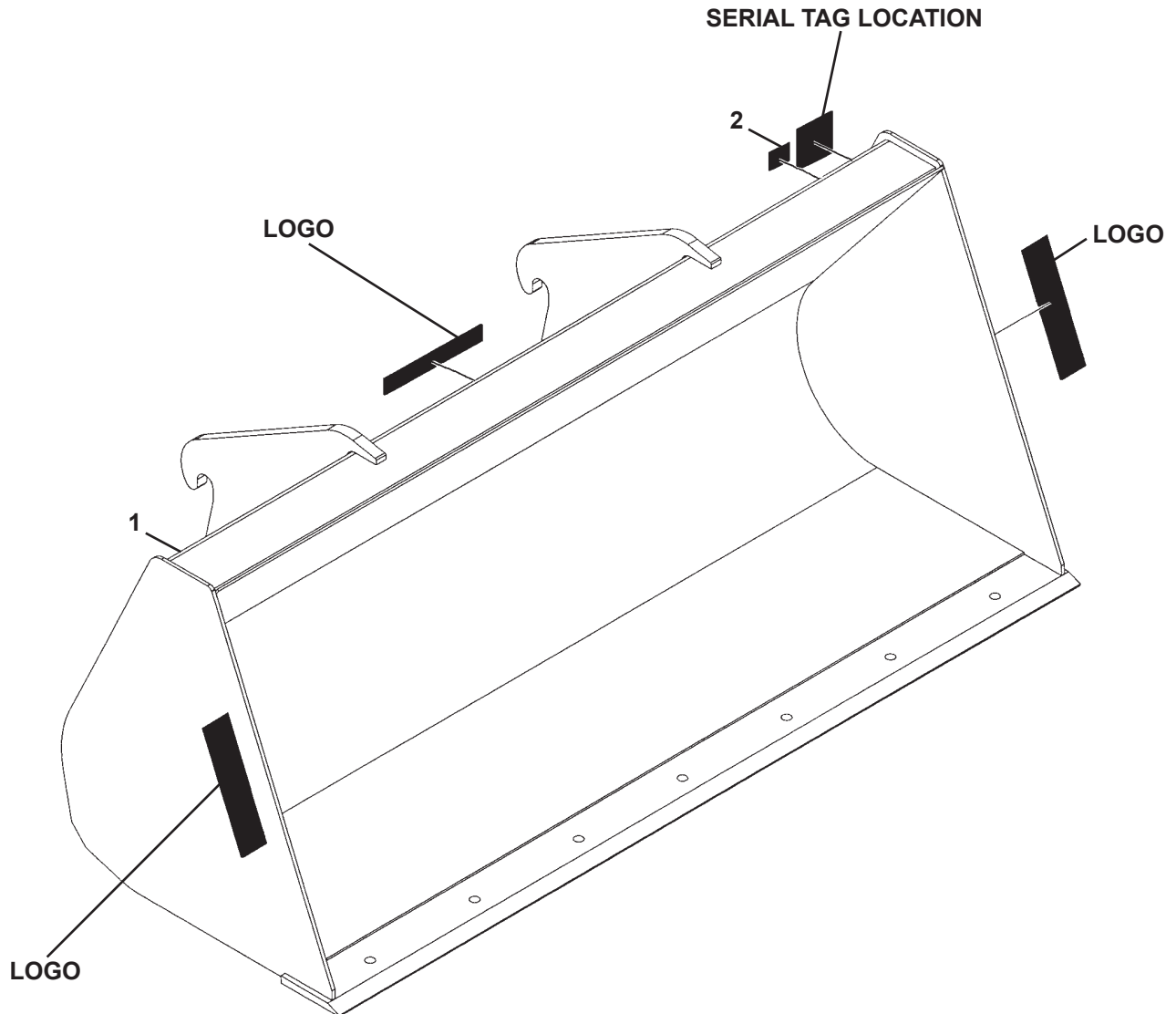

<u>ITEM</u>	<u>QTY</u>	<u>PART NO.</u>	<u>DESCRIPTION</u>
1	1	307196	Bucket, 1.00 Cubic Yard x 77" Wide
2	1	4338	Made in USA Decal

NOTE: Optional cutting edge assembly #14989 is available for this bucket.

M-2140 2-24-09

GENERAL PURPOSE BUCKET

ASSEMBLY #13162

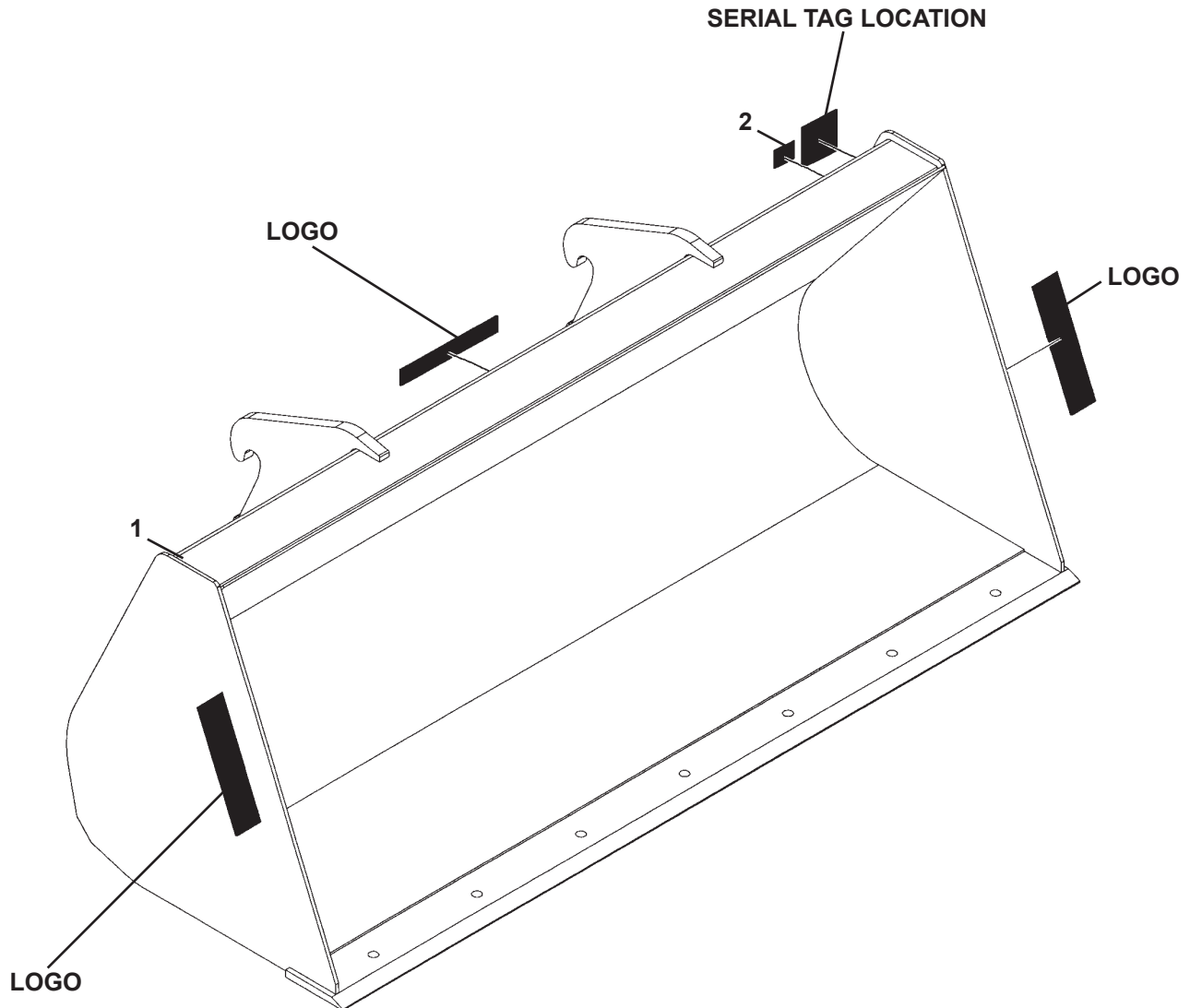

<u>ITEM</u>	<u>QTY</u>	<u>PART NO.</u>	<u>DESCRIPTION</u>
1	1	113746	Bucket, 1.00 Cubic Yard x 77" Wide
2	1	4338	Made in USA Decal

NOTE: Optional cutting edge assembly #14989 is available for this bucket.

M-2141 2-24-09

GENERAL PURPOSE BUCKET

ASSEMBLY #12530

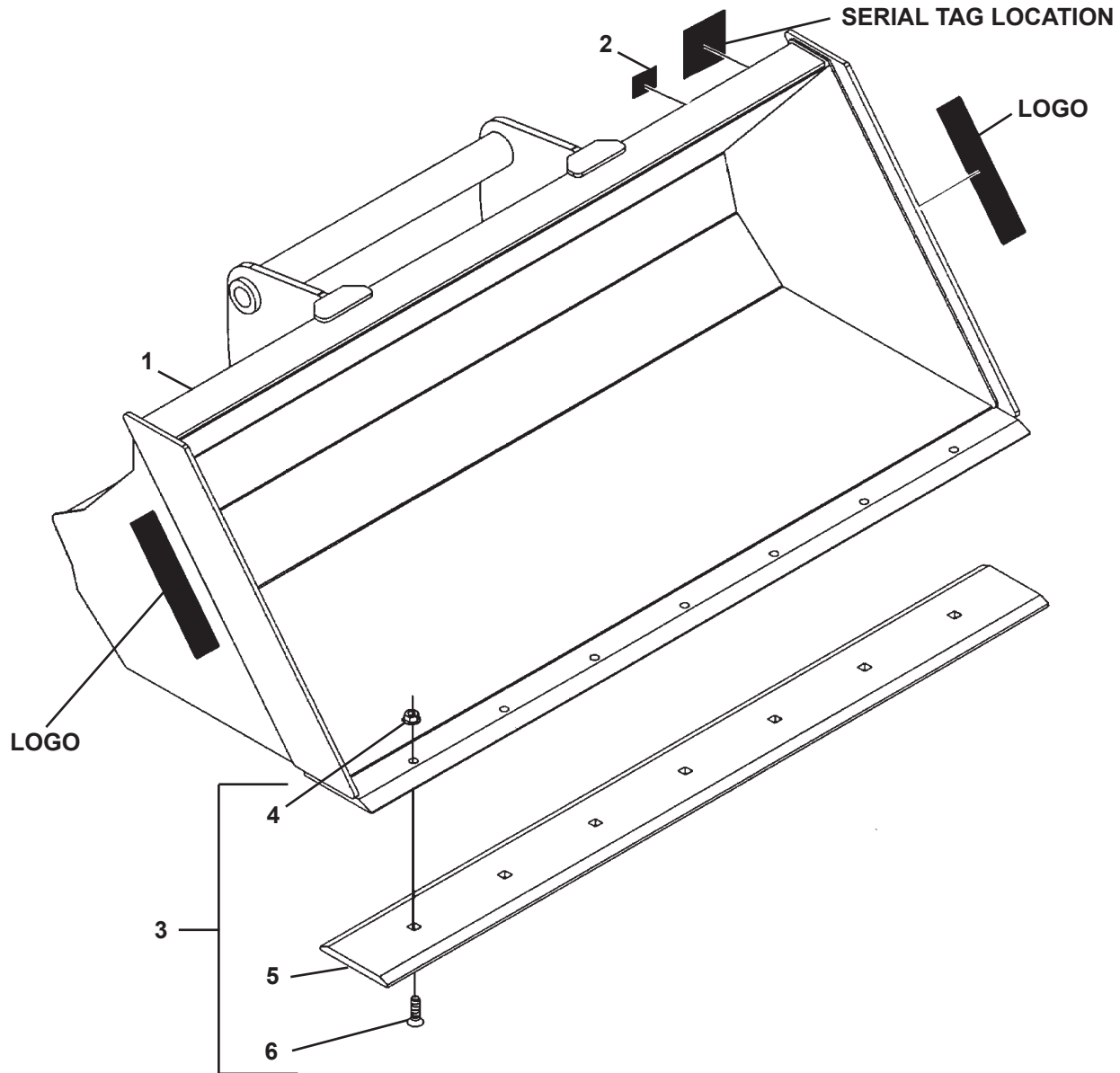

<u>ITEM</u>	<u>QTY</u>	<u>PART NO.</u>	<u>DESCRIPTION</u>
1	1	309951	Bucket, 1.00 Cubic Yard x 80" Wide
2	1	4338	Made in USA Decal
3	1	309995	Bolt-On Cutting Edge Assembly (Includes Items 4-6)
4	7	1936	.75" UNC Deformed Lock Nut
5	1	309994	Cutting Edge, .75" x 8.00" x 79.50"
6	7	10061	.75" UNC x 2.25" Plow Bolt

M-1047 2-25-09-2

GENERAL PURPOSE BUCKET

ASSEMBLY #12649

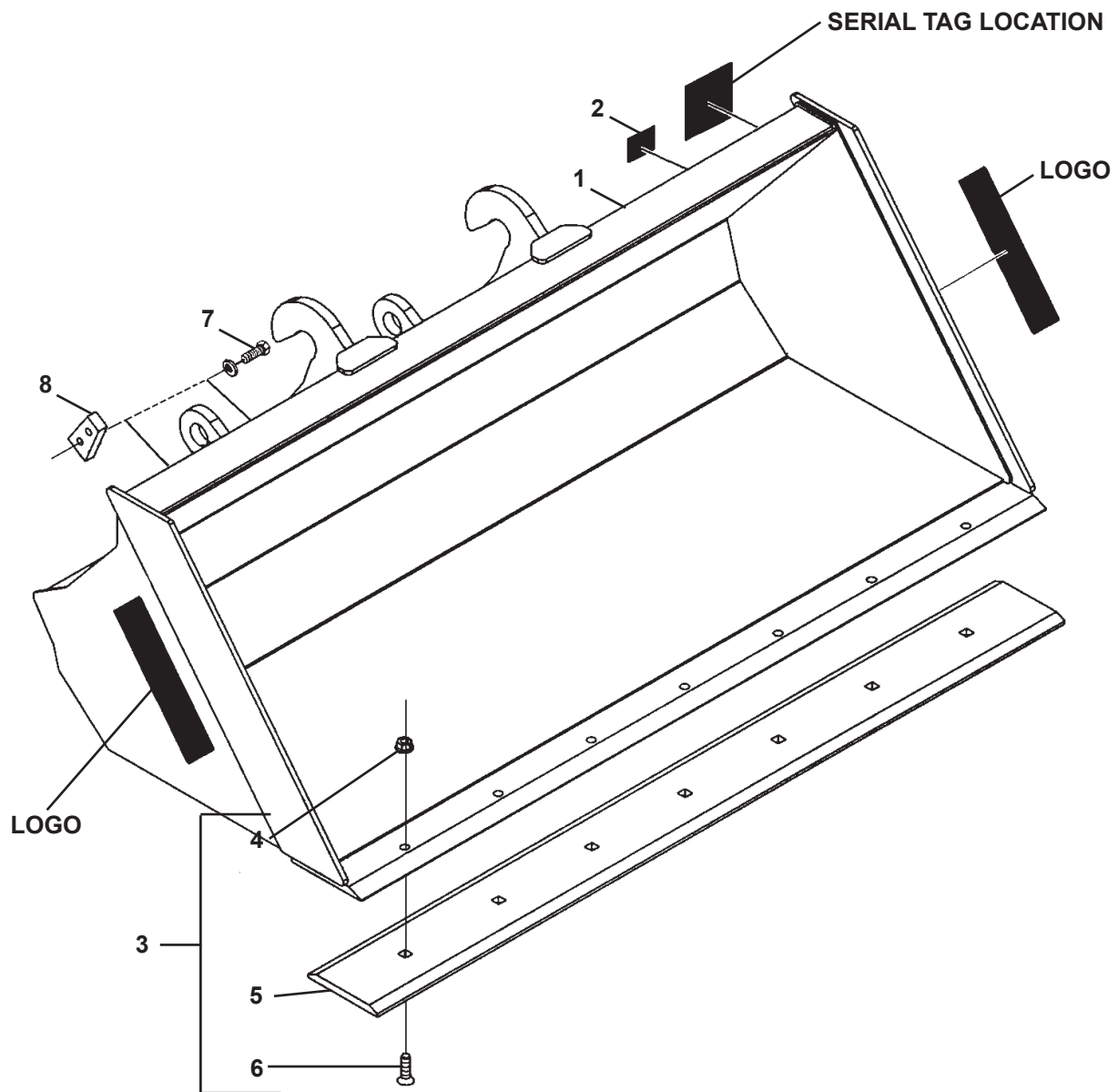

<u>ITEM</u>	<u>QTY</u>	<u>PART NO.</u>	<u>DESCRIPTION</u>
1	1	24510	Bucket, 1.00 Cubic Yard x 80" Wide
2	1	4338	Made in USA Decal
3	1	309995	Bolt-On Cutting Edge Assembly (Includes Items 4-6)
4	7	1936	.75" UNC Deformed Lock Nut
5	1	309994	Cutting Edge, .75" x 8.00" x 79.50"
6	7	10061	.75" UNC x 2.25" Plow Bolt
7	4	10012	.75" UNC x 2.25" Hex Capscrew, Grade 8
	4	1507	.75" Lock Washer
8	2	14228	Stop Block

M-989 3-2-09-3

GENERAL PURPOSE BUCKET

ASSEMBLY #12749

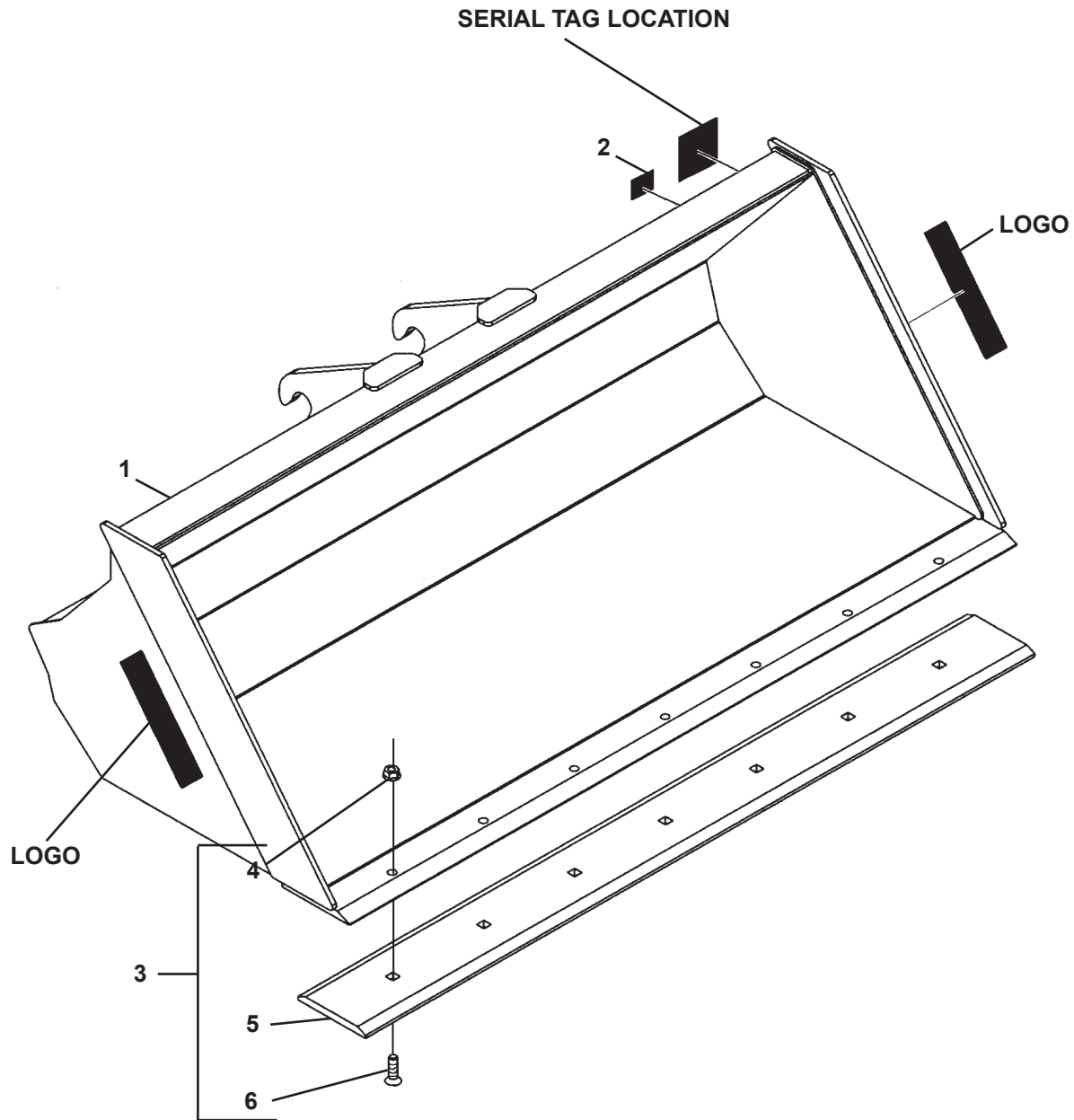

<u>ITEM</u>	<u>QTY</u>	<u>PART NO.</u>	<u>DESCRIPTION</u>
1	1	102909	Bucket, 1.00 Cubic Yard x 80" Wide
2	1	4338	Made in USA Decal
3	1	309995	Bolt-On Cutting Edge Assembly (Includes Items 4-6)
4	7	1936	.75" UNC Deformed Lock Nut
5	1	309994	Cutting Edge, .75" x 8.00" x 79.50"
6	7	10061	.75" UNC x 2.25" Plow Bolt

M-1006 3-2-09-3

GENERAL PURPOSE BUCKET

ASSEMBLY #17282

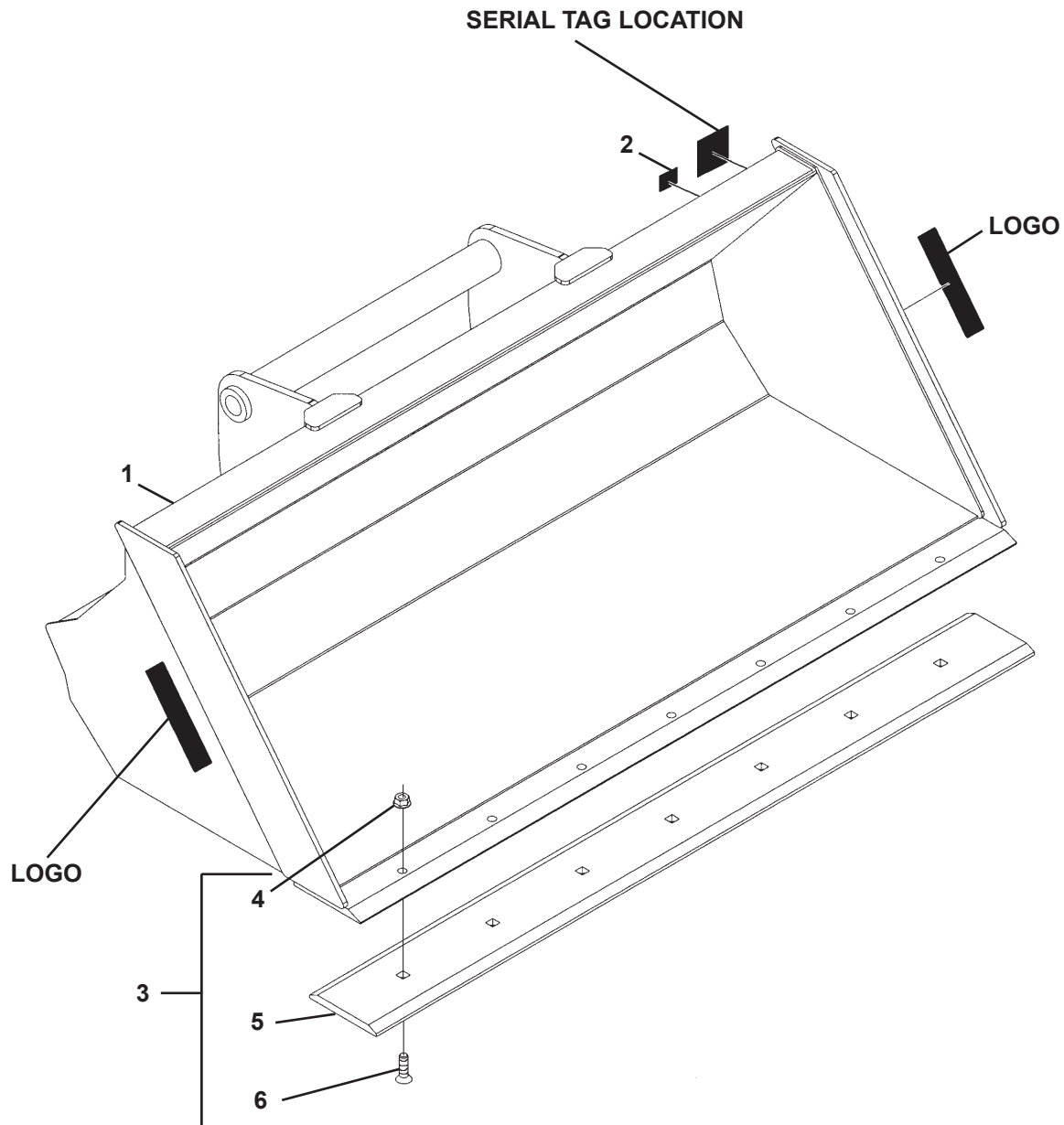

<u>ITEM</u>	<u>QTY</u>	<u>PART NO.</u>	<u>DESCRIPTION</u>
1	1	309951	Bucket, 1.00 Cubic Yard x 80" Wide
2	1	4338	Made in USA Decal
3	1	309995	Bolt-On Cutting Edge Assembly (Includes Items 4-6)
4	7	1936	.75" UNC Deformed Lock Nut
5	1	309994	Cutting Edge, .75" x 8.00" x 79.50"
6	7	10061	.75" UNC x 2.25" Plow Bolt

M-612 3-2-09-3

GENERAL PURPOSE BUCKET

ASSEMBLY #12752

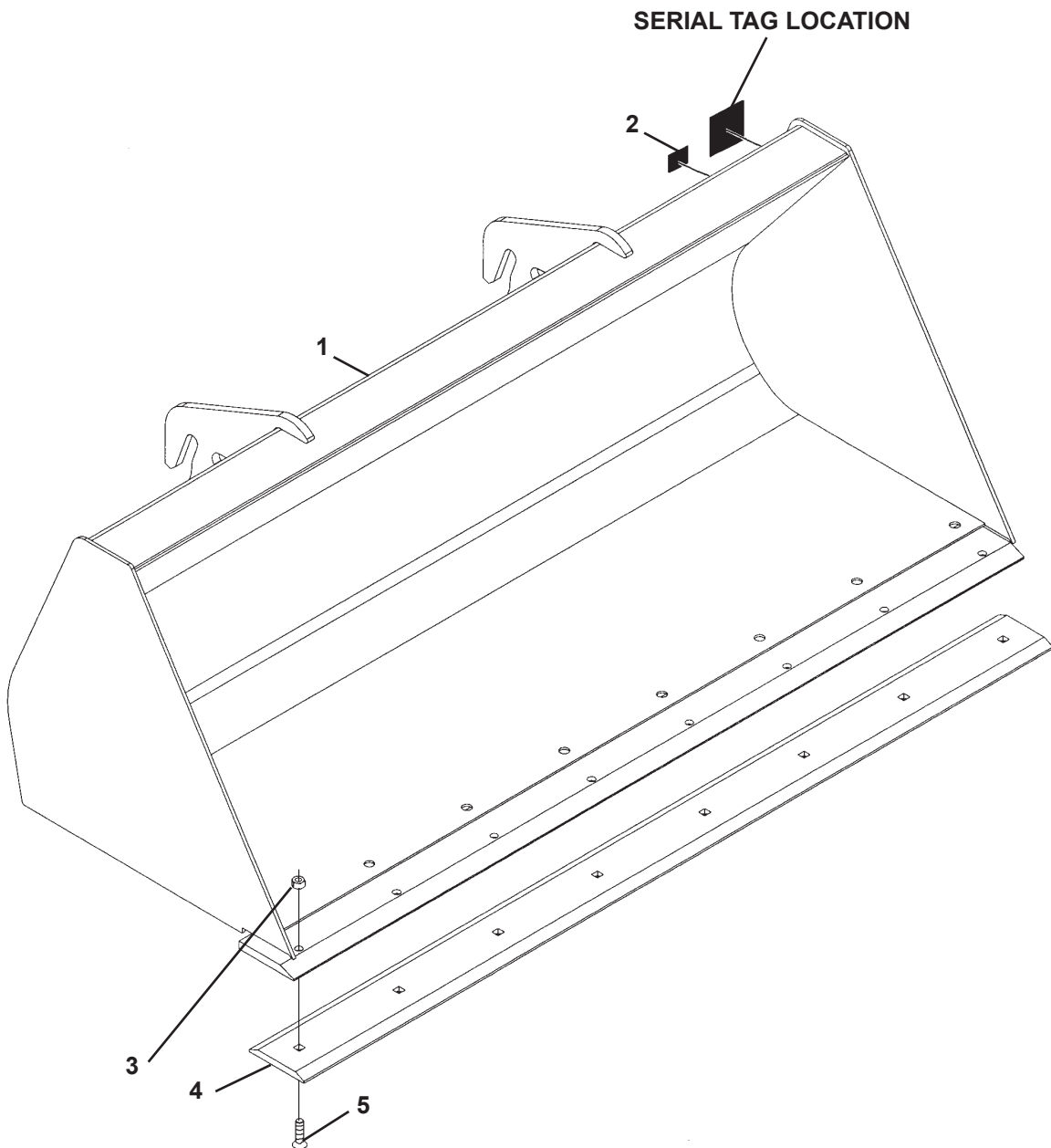

<u>ITEM</u>	<u>QTY</u>	<u>PART NO.</u>	<u>DESCRIPTION</u>
1	1	102558	Bucket, 1.00 Cubic Yard x 80.7" Wide
2	1	4338	Made in USA Decal
3	8	1839	.62" UNC Deformed Lock Nut
4	1	15214	Bolt-On Cutting Edge, .75" x 6.00" x 80.75"
5	6	10026	.62" UNC x 2.25" Plow Bolt, Grade 8

M-2172 3-17-09

GENERAL PURPOSE BUCKET

ASSEMBLY #12571

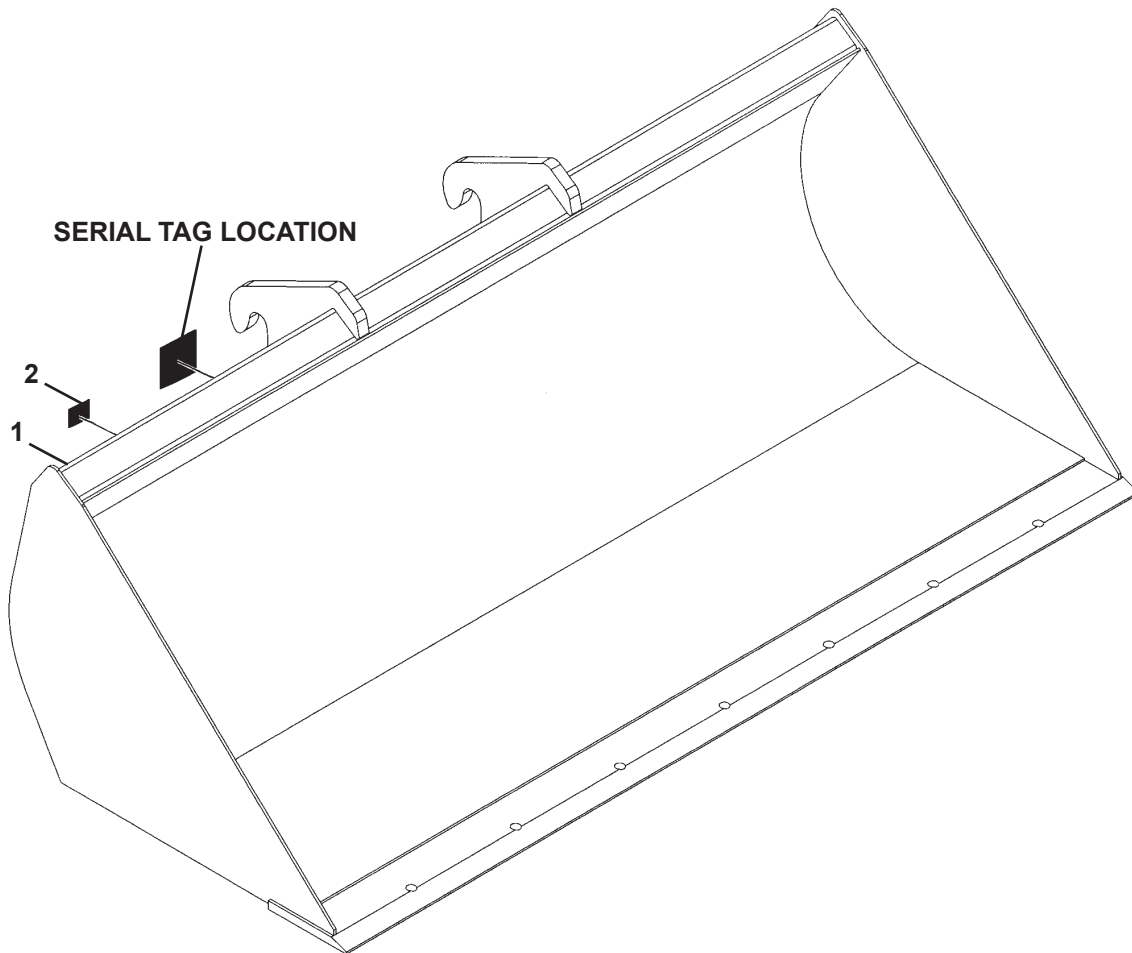

<u>ITEM</u>	<u>QTY</u>	<u>PART NO.</u>	<u>DESCRIPTION</u>
1	1	305728	Bucket, 1.00 Cubic Yard x 82" Wide
2	1	4338	Made in USA Decal

NOTE: Optional cutting edge assembly #17718 is available for this bucket.

GENERAL PURPOSE BUCKET

ASSEMBLY #12969

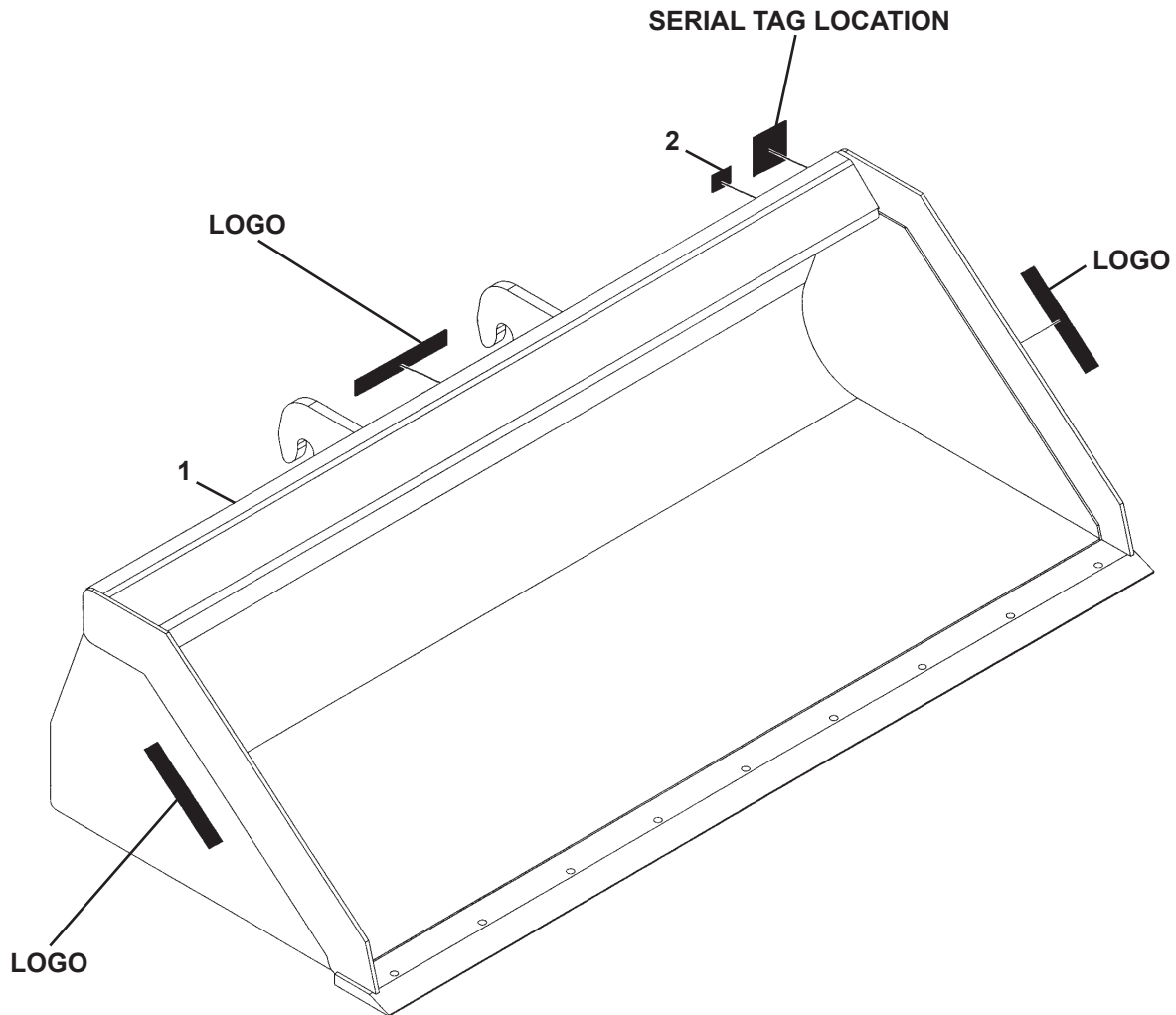

<u>ITEM</u>	<u>QTY</u>	<u>PART NO.</u>	<u>DESCRIPTION</u>
1	1	108407	Bucket, 1.00 Cubic Yard x 84" Wide
2	1	4338	Made in USA Decal

M-2131 2-24-09

GENERAL PURPOSE BUCKET

ASSEMBLY #12986

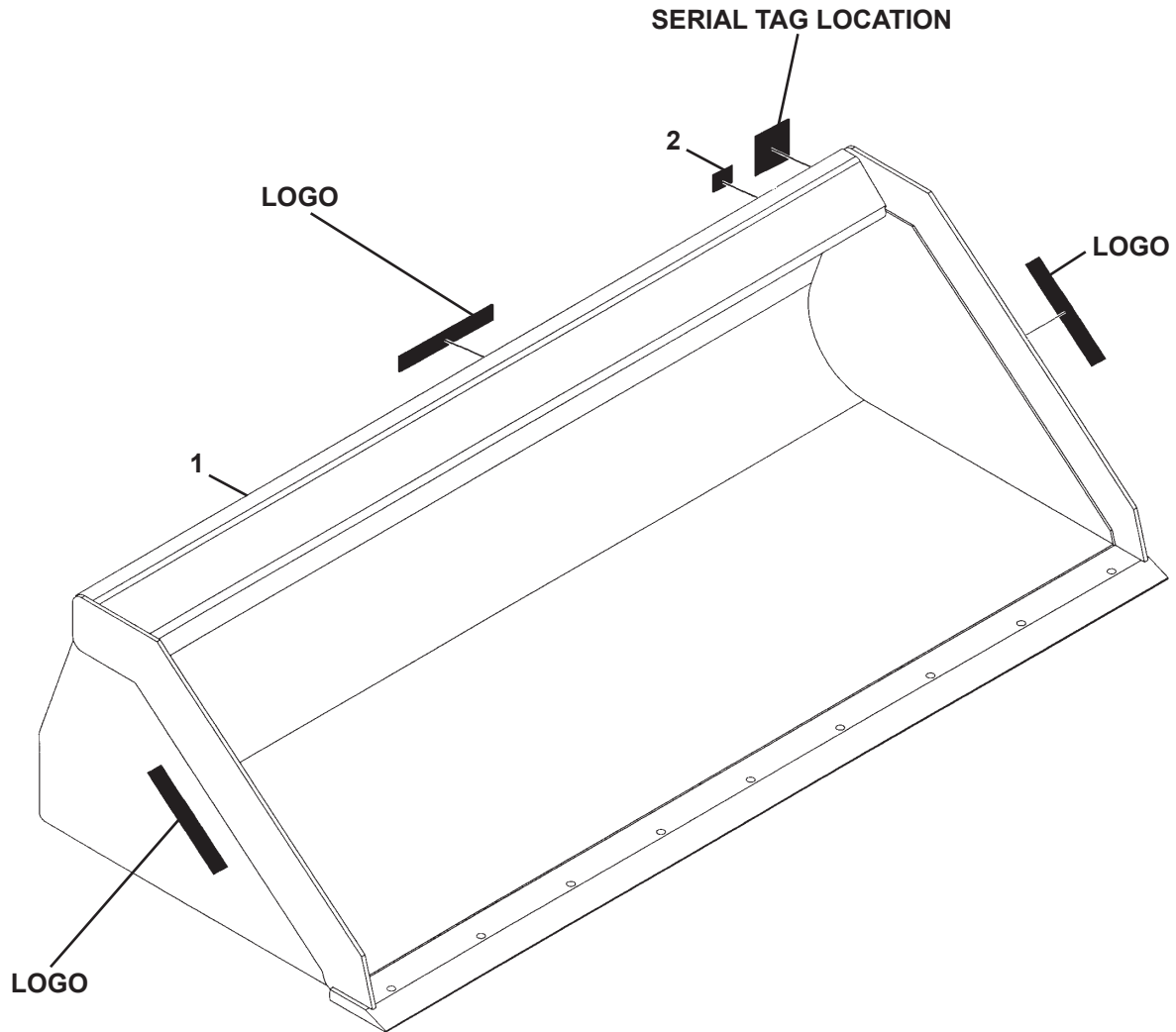

<u>ITEM</u>	<u>QTY</u>	<u>PART NO.</u>	<u>DESCRIPTION</u>
1	1	108851	Bucket, 1.00 Cubic Yard x 84" Wide
2	1	4338	Made in USA Decal

M-2134 2-24-09

GENERAL PURPOSE BUCKET

ASSEMBLY #12809

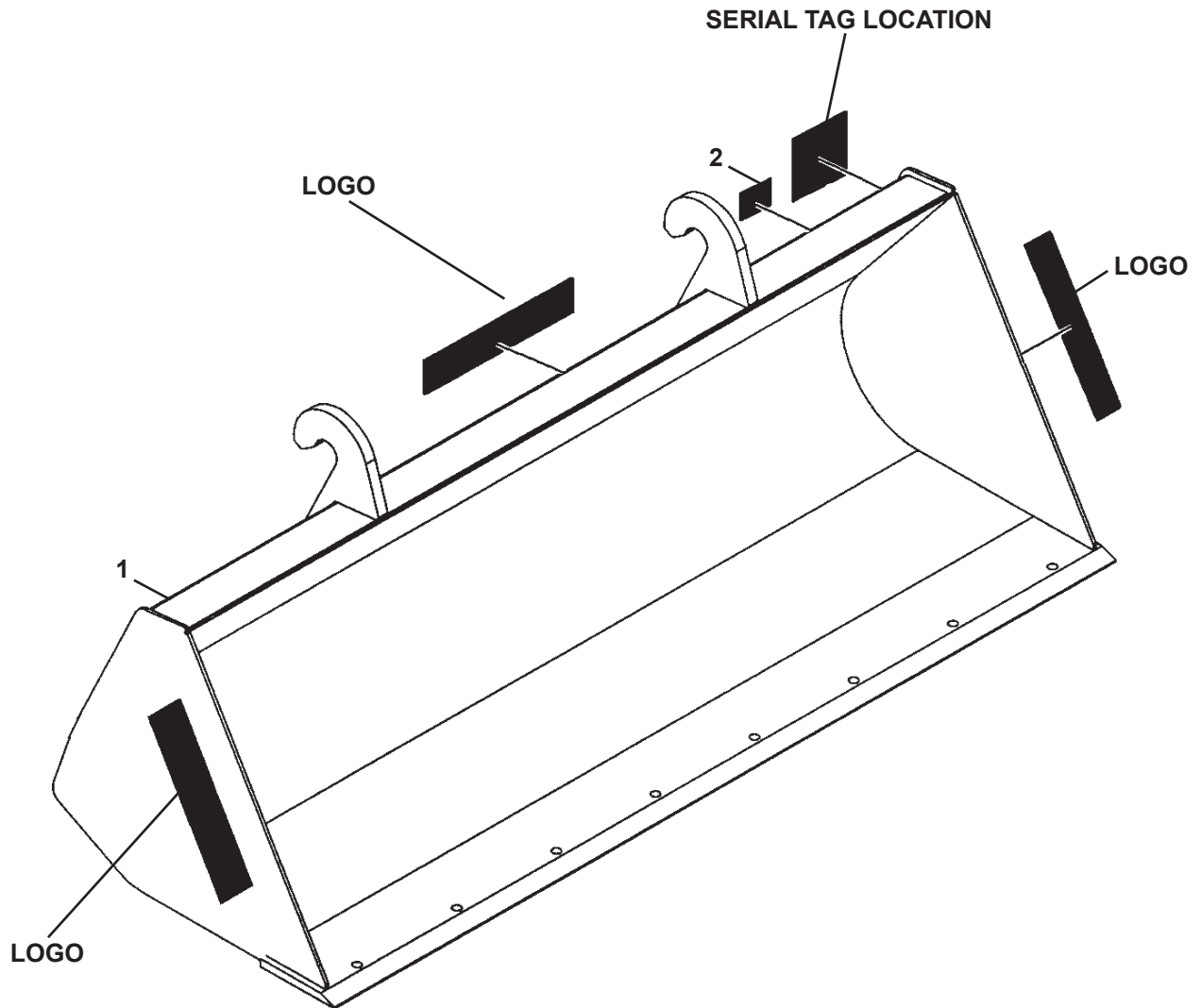

<u>ITEM</u>	<u>QTY</u>	<u>PART NO.</u>	<u>DESCRIPTION</u>
1	1	104881	Bucket, 1.00 Cubic Yard x 85.00" Wide
2	1	4338	Made in USA Decal

NOTE: Optional cutting edge assembly #12812 is available for this bucket.

GENERAL PURPOSE BUCKET

ASSEMBLY #11036

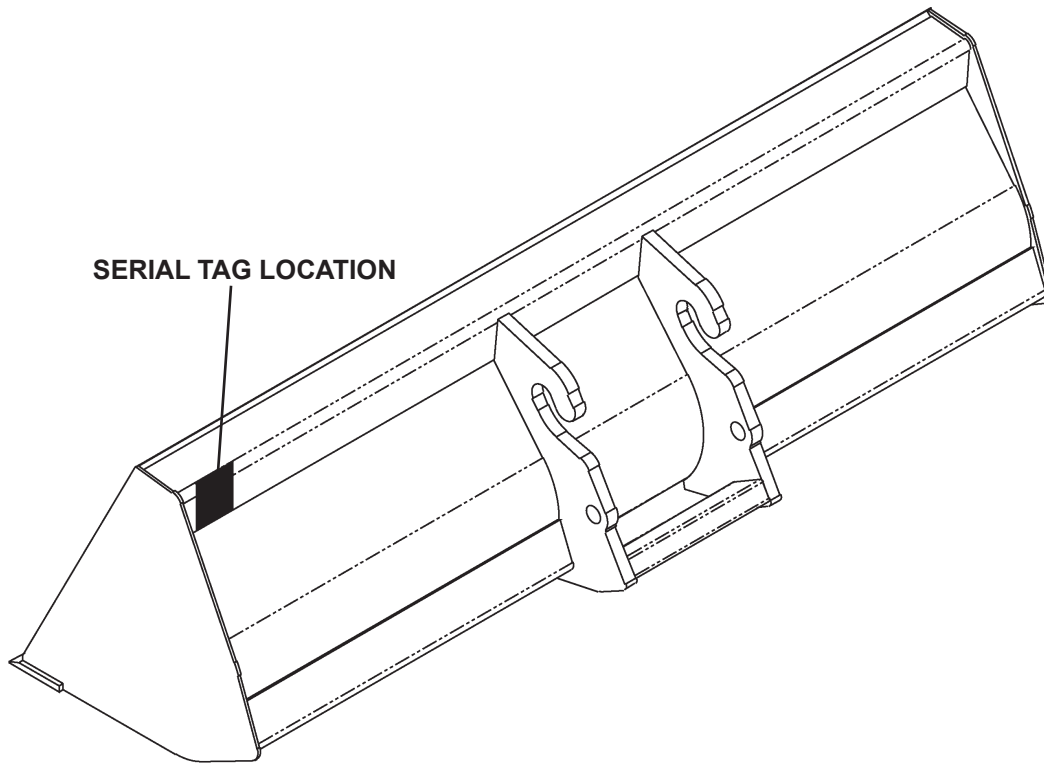

<u>ITEM</u>	<u>QTY</u>	<u>PART NO.</u>	<u>DESCRIPTION</u>
1	1	14702	Bucket, 1.00 Cubic Yard x 96" Wide

NOTE: Optional cutting edge assembly #11002 is available for this bucket.

M-315 2-24-09-2

GENERAL PURPOSE BUCKET

ASSEMBLY #12589

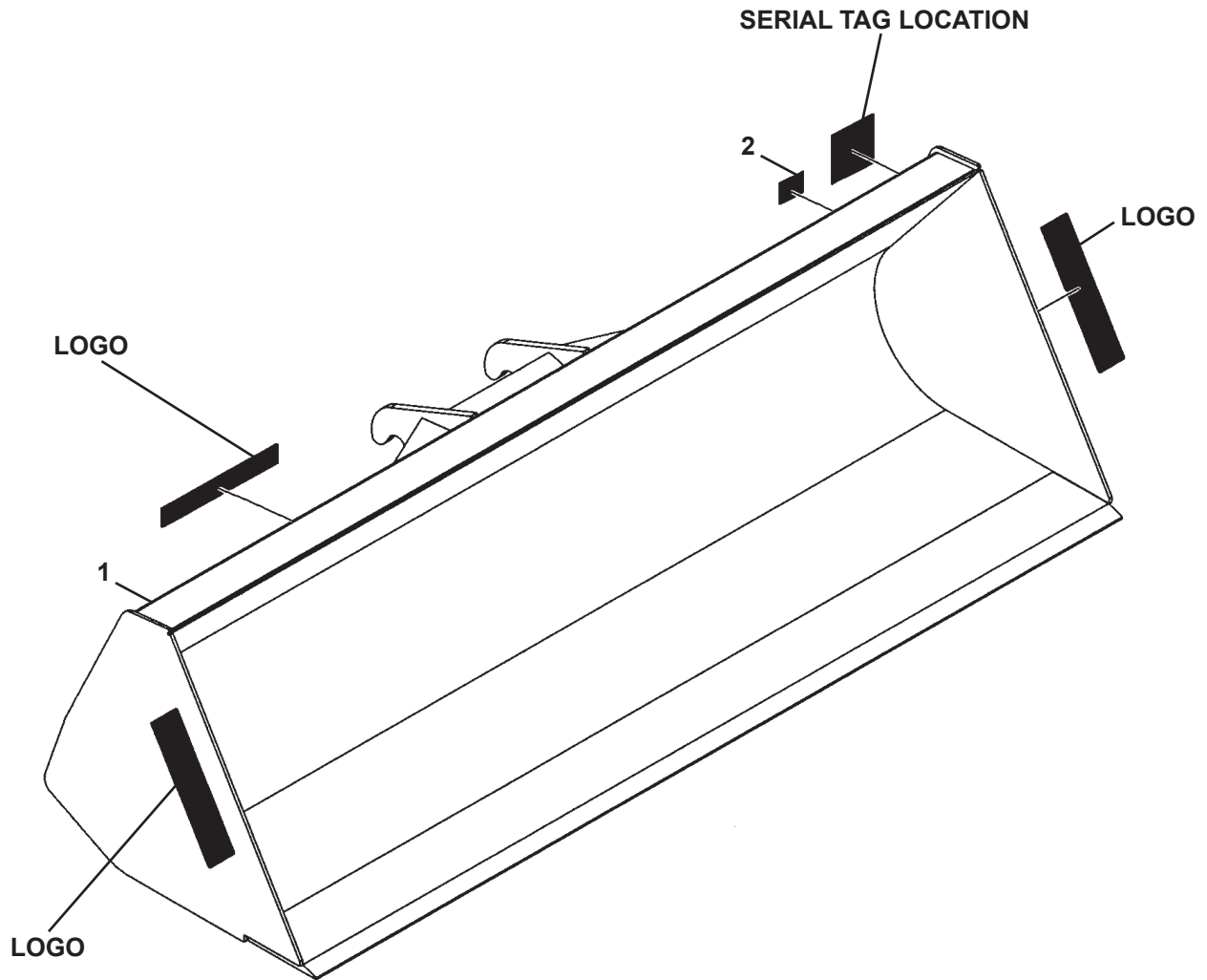

<u>ITEM</u>	<u>QTY</u>	<u>PART NO.</u>	<u>DESCRIPTION</u>
1	1	308079	Bucket, 1.00 Cubic Yard x 96.00" Wide
2	1	4338	Made in USA Decal

NOTE: Optional cutting edge assembly #11002 is available for this bucket.

GENERAL PURPOSE BUCKET

ASSEMBLY #12968

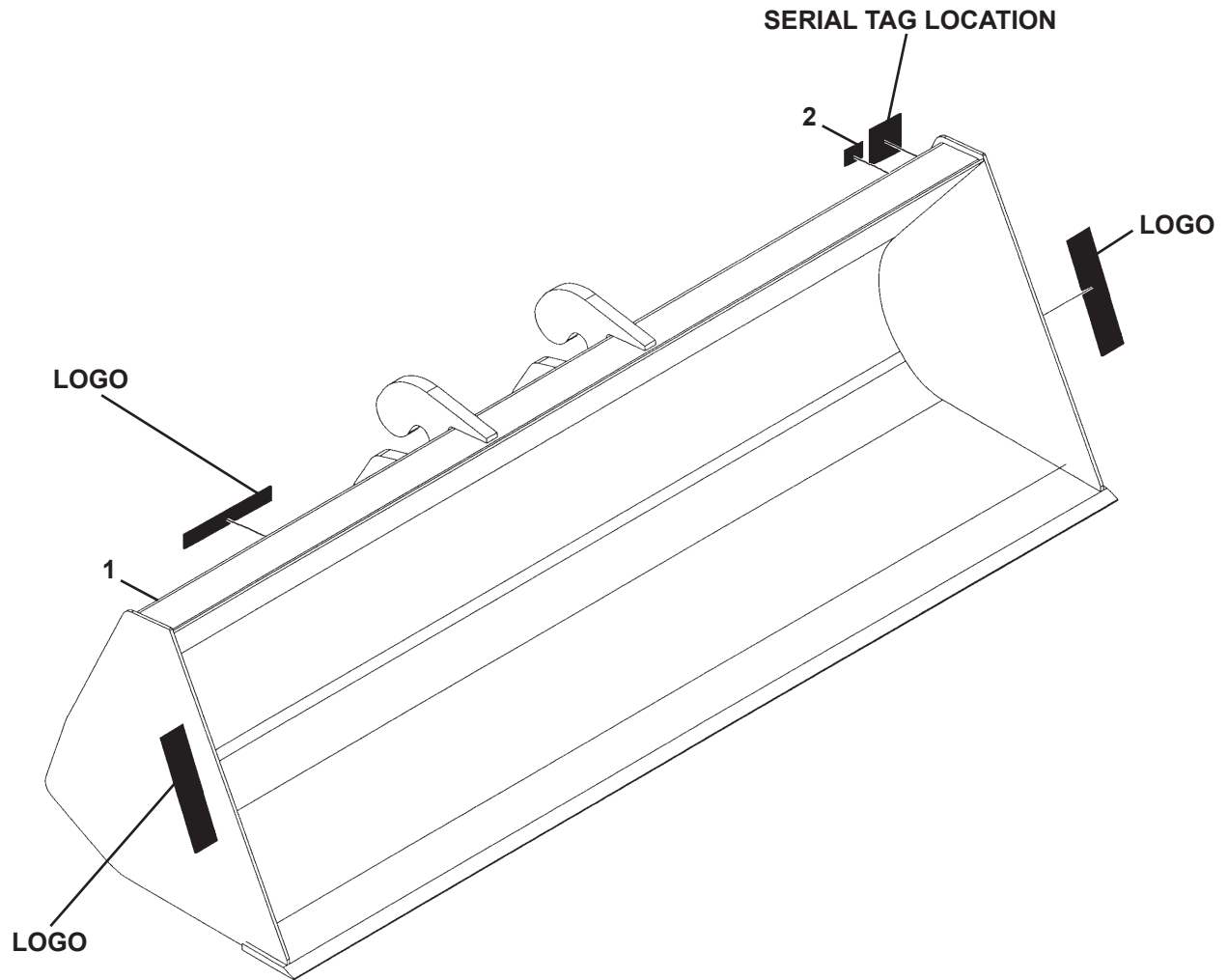

<u>ITEM</u>	<u>QTY</u>	<u>PART NO.</u>	<u>DESCRIPTION</u>
1	1	108346	Bucket, 1.00 Cubic Yard x 96" Wide
2	1	4338	Made in USA Decal

M-2142 2-24-09

CUTTING EDGE

ASSEMBLY #18682

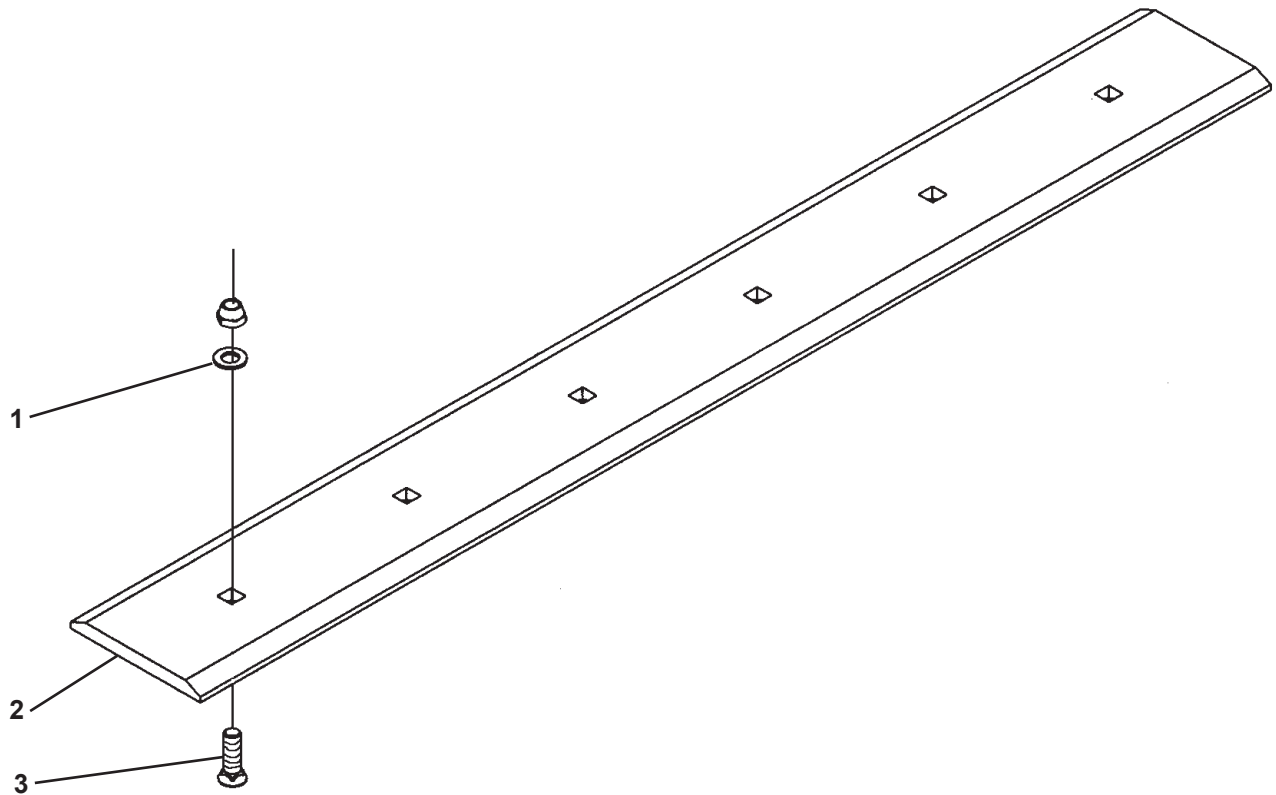

<u>ITEM</u>	<u>QTY</u>	<u>PART NO.</u>	<u>DESCRIPTION</u>
1	6	1936	.75" UNC Deformed Lock Nut
2	6	1649	.75" Hard Flat Washer
3	1	18683	Bolt-On Cutting Edge, .75" x 8.00" x 66.00"
4	6	1937	.75" UNC x 2.50" Plow Bolt

M-1037 3-2-09-2

CUTTING EDGE

ASSEMBLY #12504

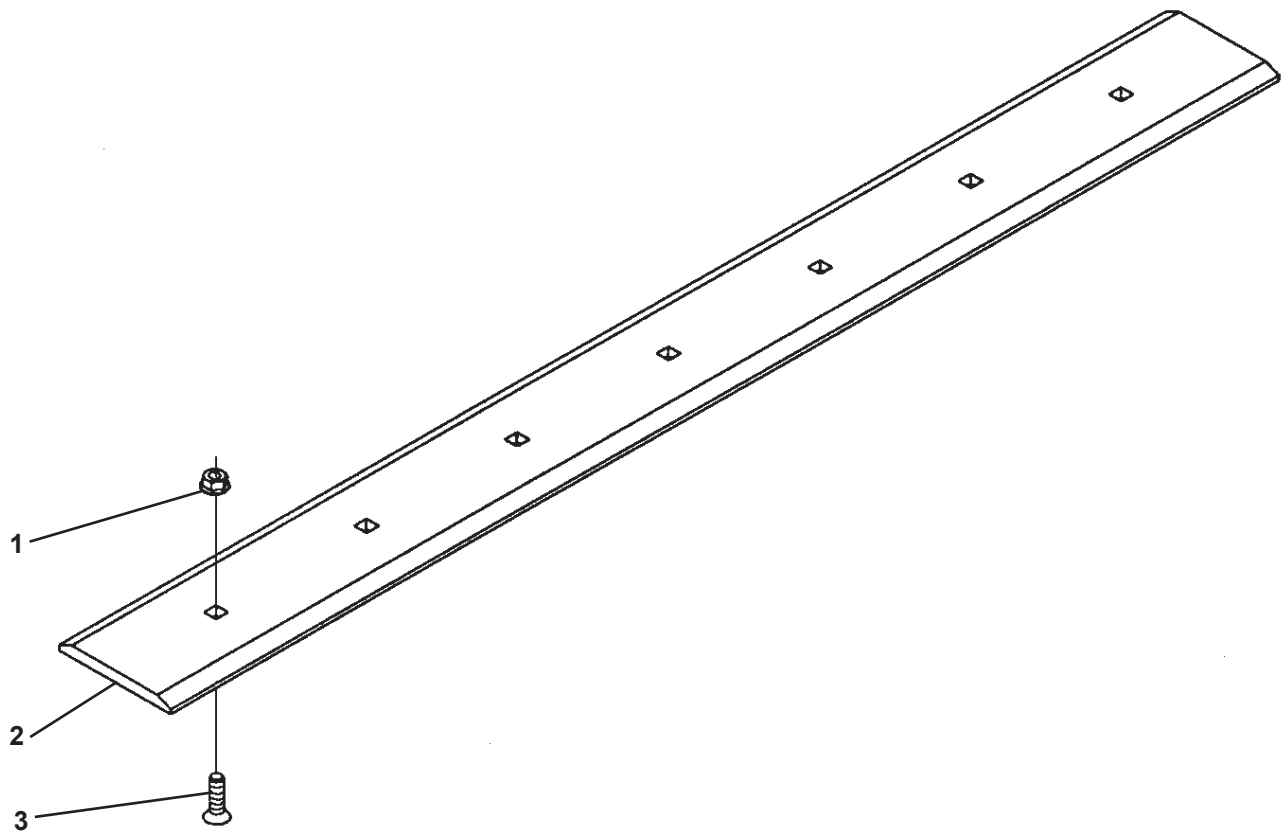

<u>ITEM</u>	<u>QTY</u>	<u>PART NO.</u>	<u>DESCRIPTION</u>
1	7	1839	.62" UNC Deformed Lock Nut
2	1	11988	Bolt-On Cutting Edge, .62" x 6.00" x 72.00"
3	7	102717	.62" UNC x 1.75" Plow Bolt, Grade 8

CUTTING EDGE

ASSEMBLY #14989

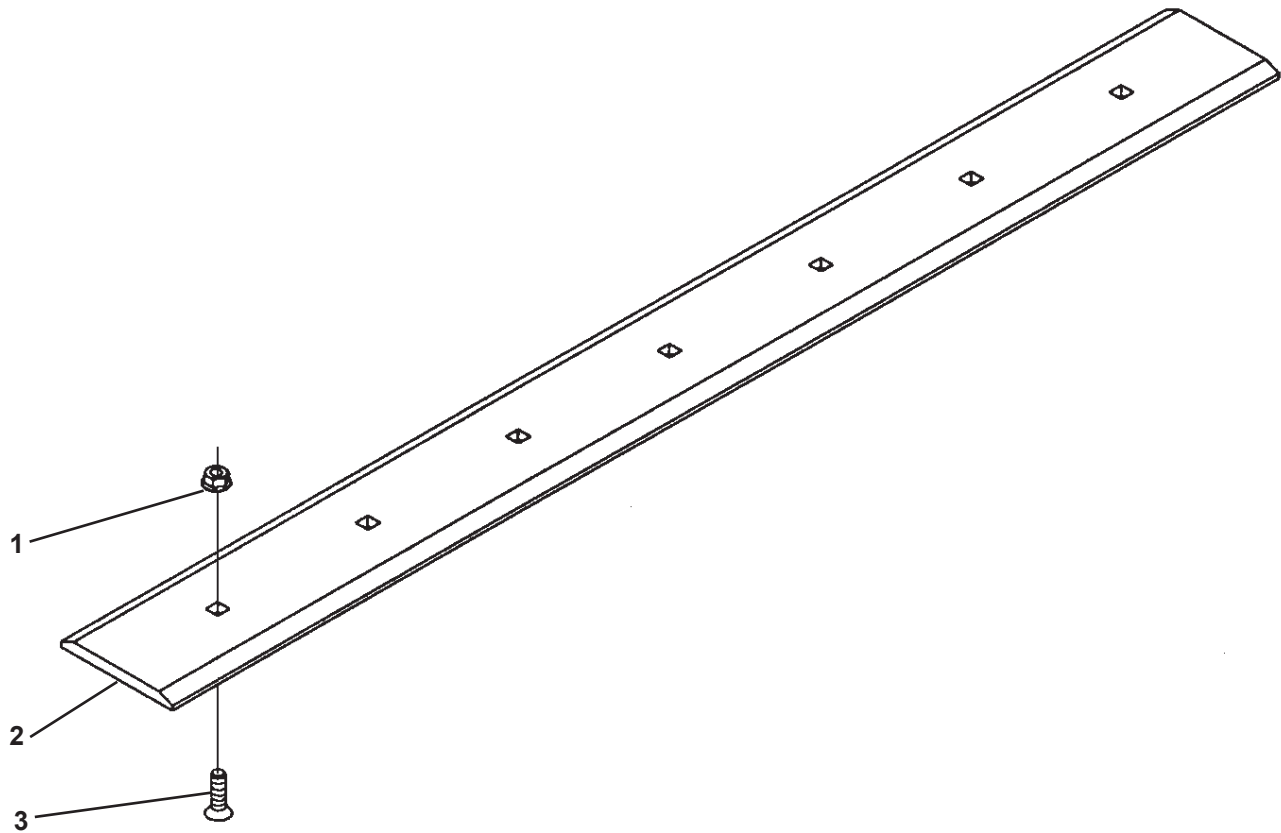

<u>ITEM</u>	<u>QTY</u>	<u>PART NO.</u>	<u>DESCRIPTION</u>
1	7	1936	.75" UNC Deformed Lock Nut
2	1	14988	Bolt-On Cutting Edge, .75" x 8.00" x 77.00"
3	7	1937	.75" UNC x 2.50" Plow Bolt

M-1042 3-2-09-2

CUTTING EDGE

ASSEMBLY #309995

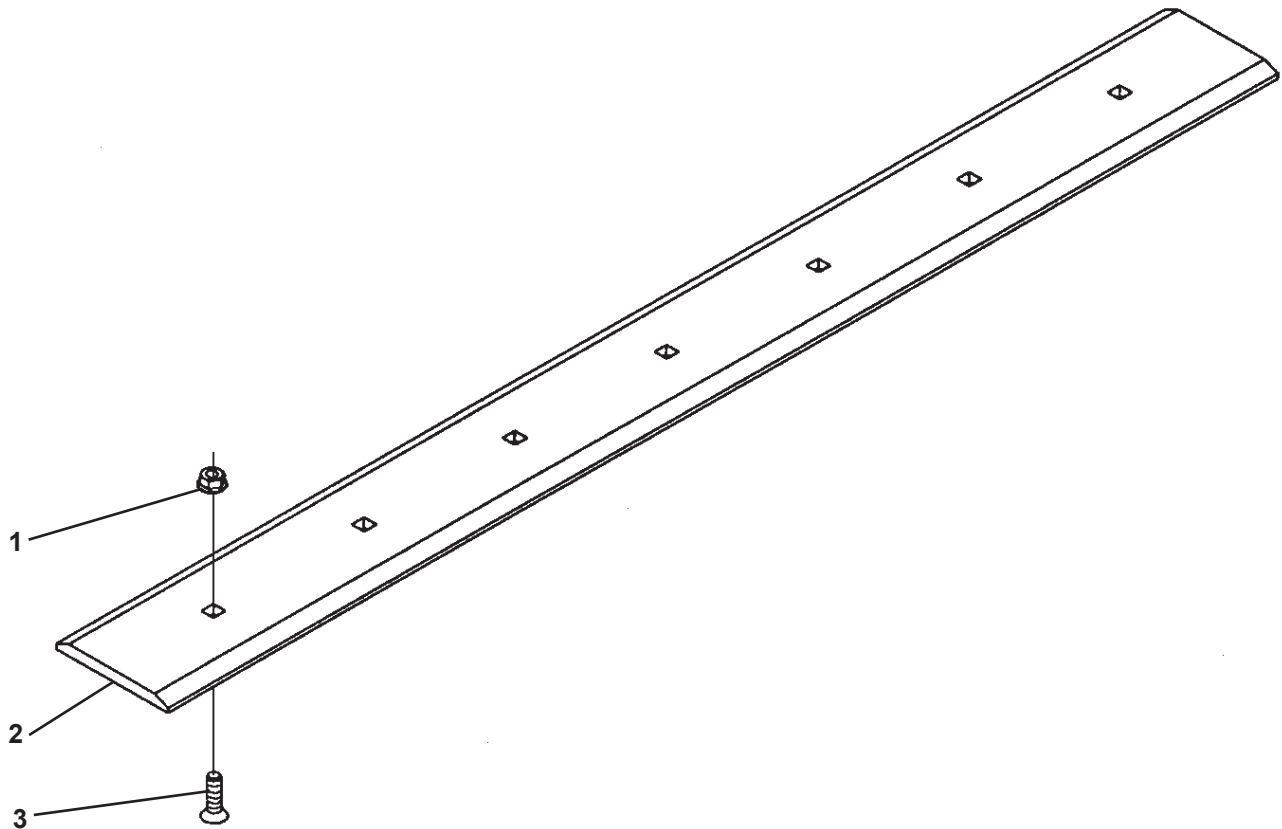

<u>ITEM</u>	<u>QTY</u>	<u>PART NO.</u>	<u>DESCRIPTION</u>
1	7	1936	.75" UNC Deformed Lock Nut
2	1	309994	Bolt-On Cutting Edge, .75" x 8.00" x 79.50"
3	7	10061	.75" UNC x 2.25" Plow Bolt

CUTTING EDGE

ASSEMBLY #17718

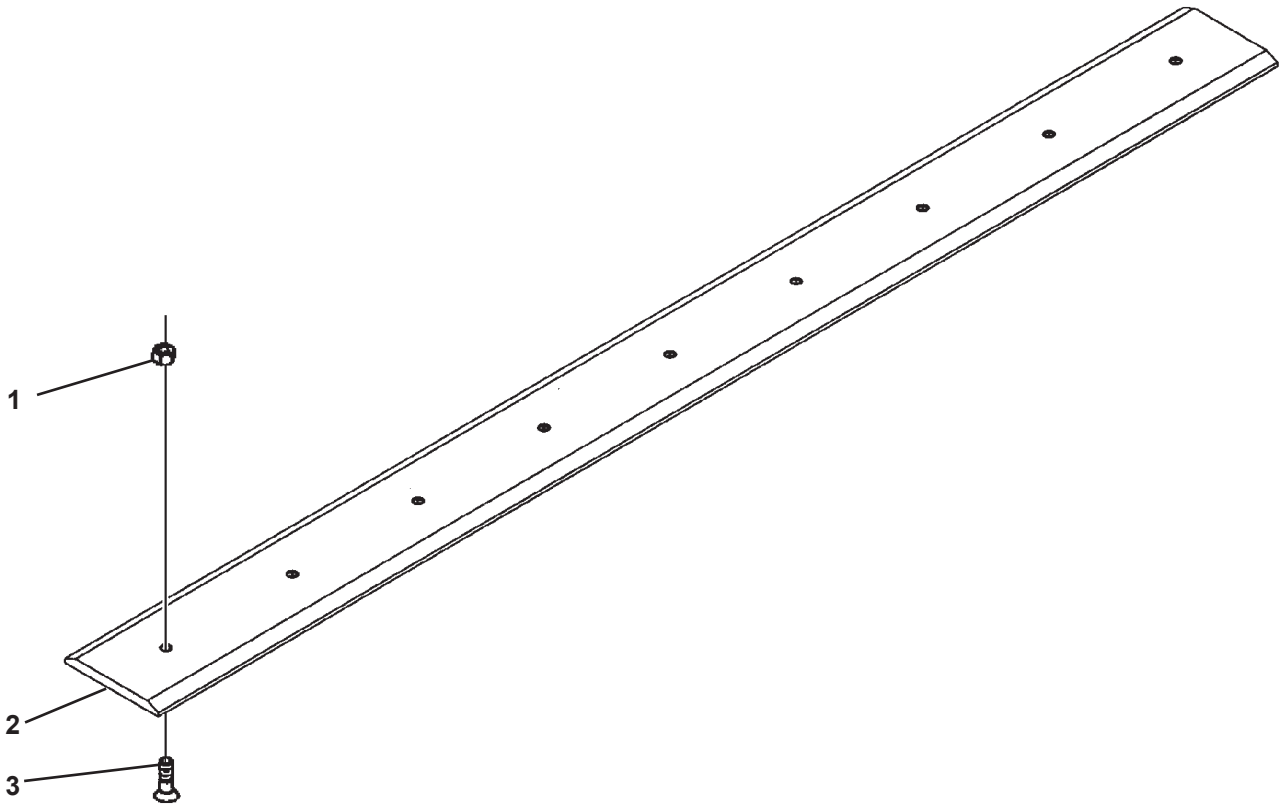

<u>ITEM</u>	<u>QTY</u>	<u>PART NO.</u>	<u>DESCRIPTION</u>
1	7	1936	.75" UNC Deformed Lock Nut
2	1	17719	Bolt-On Cutting Edge, .75" x 8.00" x 82.00"
3	7	1937	.75" UNC x 2.50" Plow Bolt

CUTTING EDGE

ASSEMBLY #12812

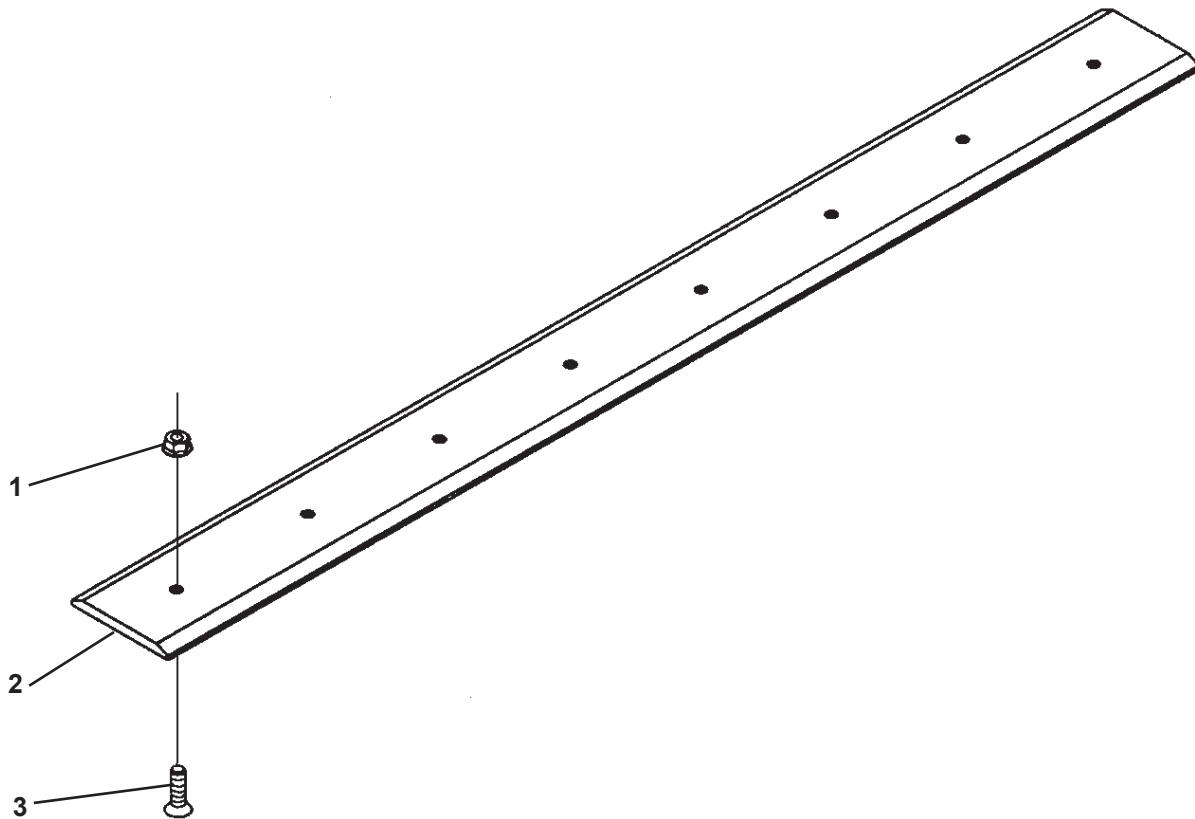

<u>ITEM</u>	<u>QTY</u>	<u>PART NO.</u>	<u>DESCRIPTION</u>
1	8	1936	.75" UNC Deformed Lock Nut
2	1	104901	Bolt-On Cutting Edge, .75" x 8.00" x 85.17"
3	8	1937	.75" UNC x 2.50" Plow Bolt

M-1070 3-2-09-2

CUTTING EDGE

ASSEMBLY #11002

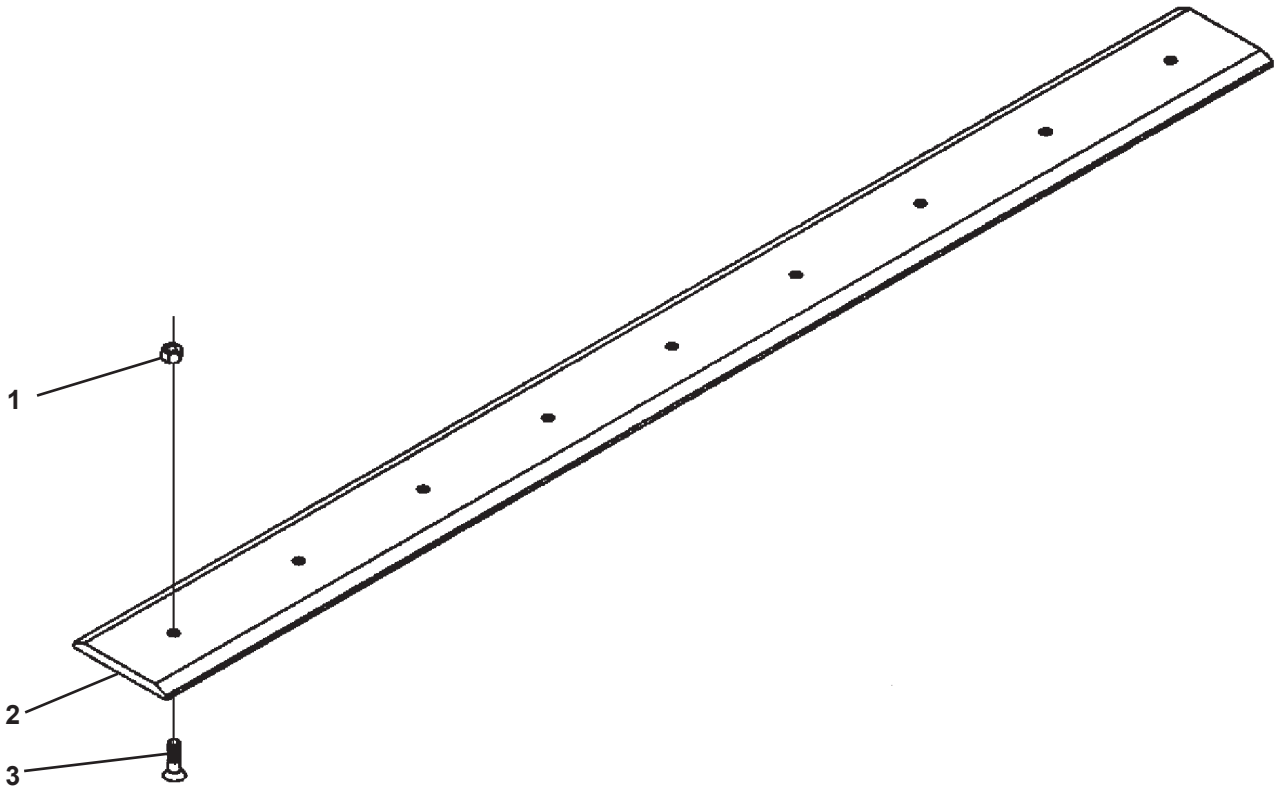

<u>ITEM</u>	<u>QTY</u>	<u>PART NO.</u>	<u>DESCRIPTION</u>
1	9	1936	.75" UNC Deformed Lock Nut
2	1	12245	Bolt-On Cutting Edge, .75" x 8.00" x 96.00"
3	9	1937	.75" UNC x 2.50" Plow Bolt

M-1051 3-2-09-2

**THIS PAGE
IS INTENTIONALLY
BLANK**



(563) 922-2981
(800) 456-7100

www.paladinattachments.com